

256A DPL VERTICAL 50120V LIFT W/CHAIN DRIVE WINCH
255A FPB VERTICAL 50120V LIFT W/CHAIN DRIVE WINCH

Thank you for purchasing our product!

Please read these instructions and follow them step by step.

Step 1. Separate and group like parts and fasteners together. Locate the four 3 1/2" x 3 1/2" x 32" leveling leg tubes with multiple holes (**Ref. # 3**) and the four leveling pads (**Ref. # 4**) bolt channel of pad to leveling leg tube with 1/2" x 5" bolt and nut (**Ref. # 18 & 23**)

Step 2. Locate the 3 1/2" x 3 1/2" x 26" winch mount tube (**Ref. # 5**) and the chain drive winch (**Ref. # 10**) remove outside guard from the winch and bolt the winch to the tube with 3/8" x 4 1/2" bolts, fender washers, and nuts. (**Ref. # 22, 25 & 27**)

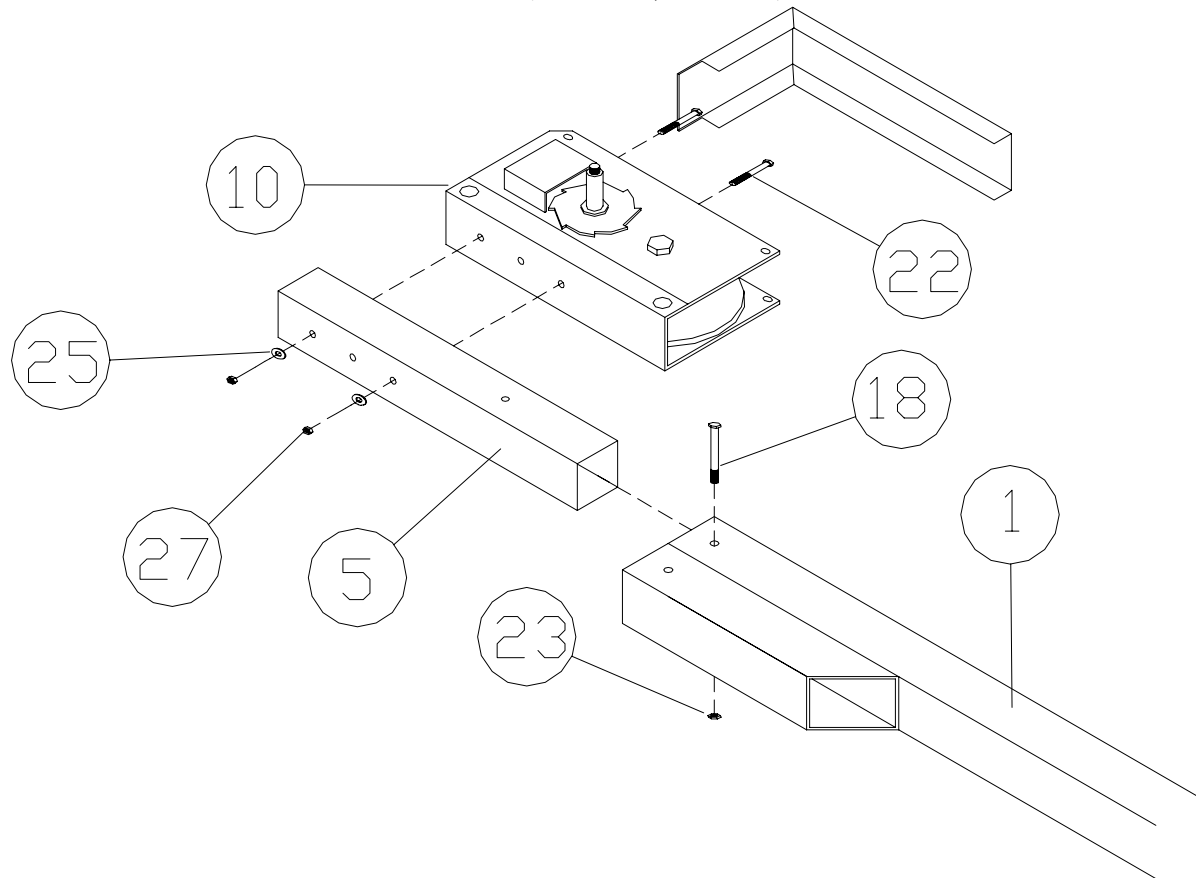

Step 3. Locate the winch side member with the diagonal braces (**Ref. #1**). Lay the winch side member on its side with the corner angles facing up. Slide the winch and mounting tube into the side member upright that has the extra pocket welded onto it's outside. **Have the winch facing toward the inside of the lift.** Bolt in place with 1/2" x 5" bolt and nut. Slide the leveling legs into the uprights so that the holes in the leveling leg are toward the outside of the lift. Pin leveling legs into the lowest position with a 1/2" x 5" clevis pin and clip (**Ref. #30 & 31**). Locate the two 4" x 4" x 110 1/2" bottom cross tubes (**Ref. #6**). Using two people, stand the side member up on it's leveling legs. With one person balancing the side member, bolt the bottom cross tubes to the corner angles of the side member using 1/2" x 5 1/2" bolts and nuts (**Ref. # 19 & 23**). Leave nuts finger tight at this time.

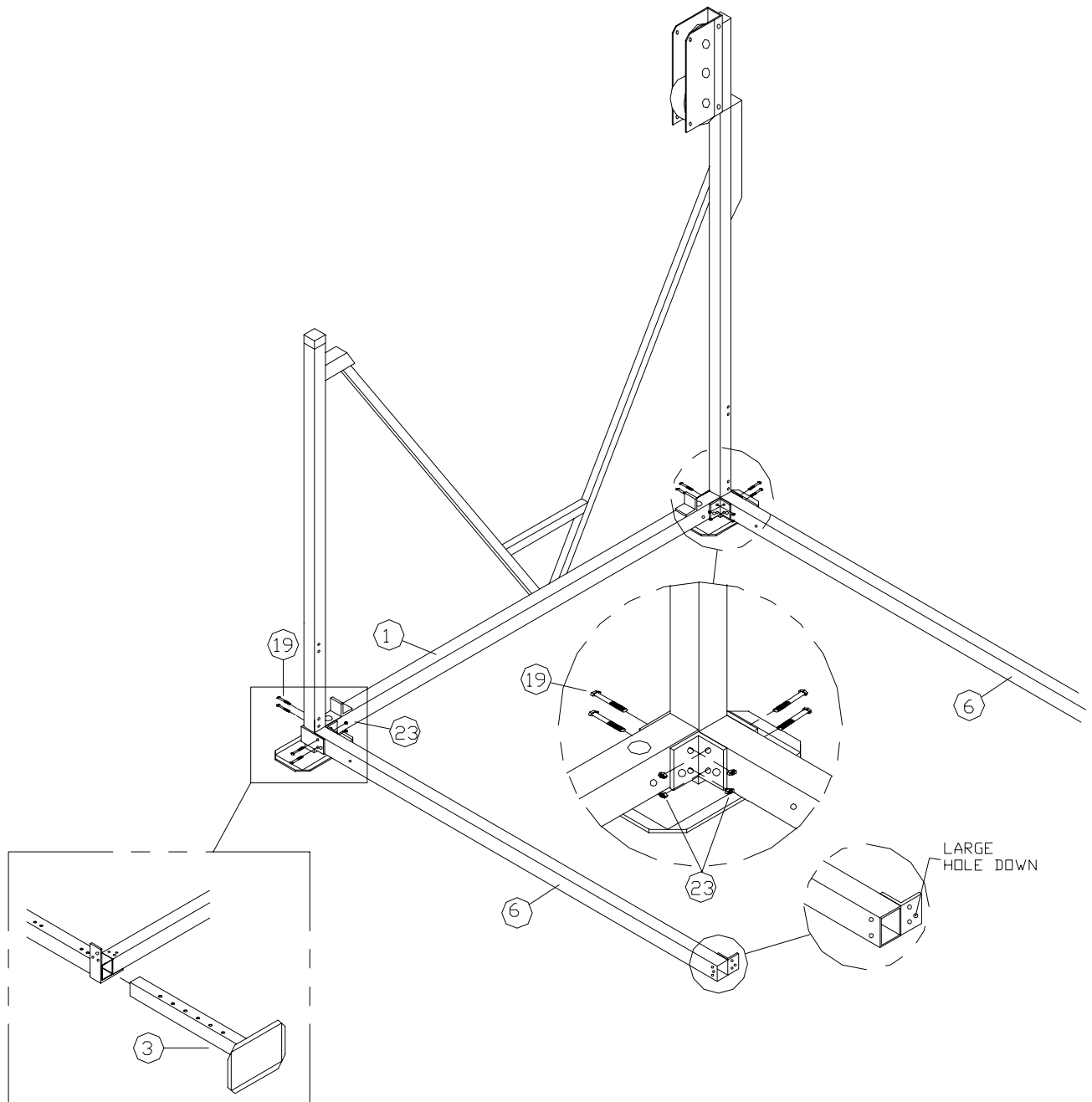

Step 4. Slide leveling legs into the anchor side member (**Ref. #2**) and pin in place as done to other side member. Using two people stand the side member up. Bolt anchor side member up to the ends of the bottom cross tubes. Using 1/2"x 5 1/2" bolts and nuts (**Ref. #19 & 23**). At this time, leave the bolt out of the single centered hole at the ends of the side members. Finger tighten nuts.

Step 5. Locate the top bed cross tubes, (2" X 6" X 126"), the tube with the single cable protruding from each end, is the winch bed cross tube (**Ref. # 7**). From the inside of the lift frame, on the winch end, place the top bed cross tube across the end of the lift so that the nylon slide angles are up against the inside corners of the side member uprights. Take the other top bed cross tube with the two cables protruding from the ends (**Ref. # 8**) and place across the other end of the lift frame, so that the bottom loops of the cable are in the holes in the bottom side tube of the side member. The nylon slide angles should be against the inside corner of the upright tubes.

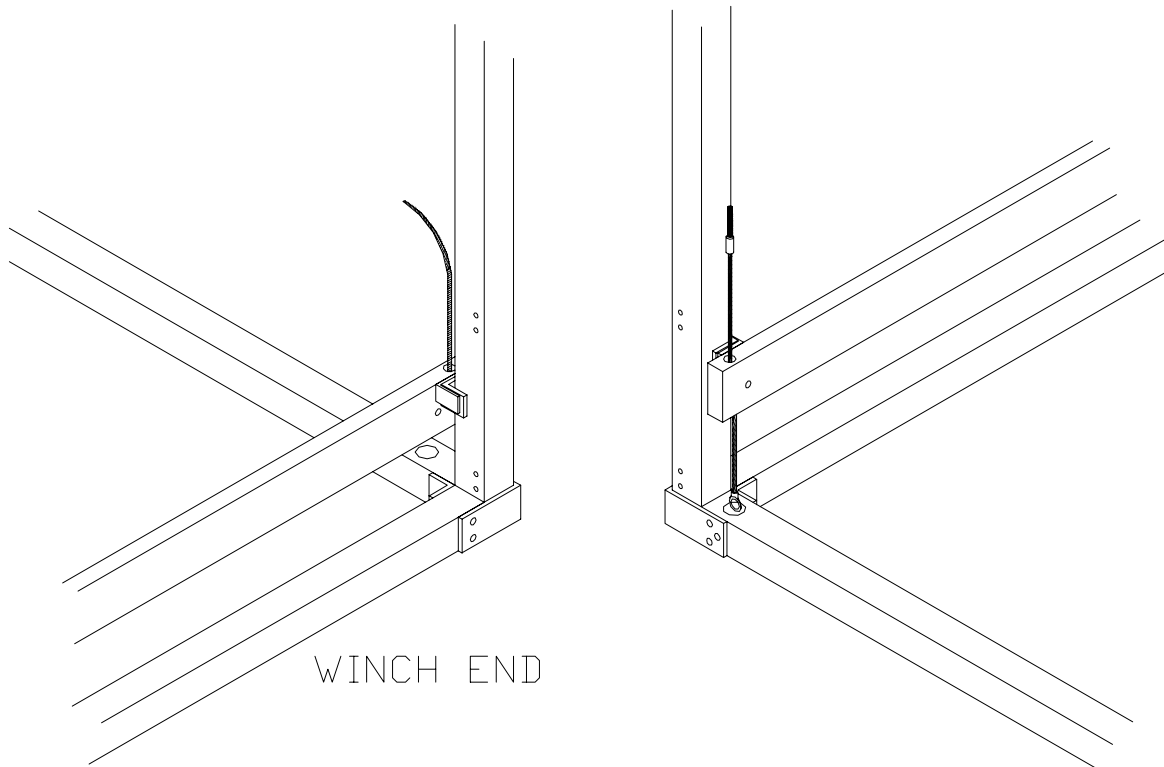

Step 6. Find the two 2" x 4 11/16" x 129 1/2" top bed side rail assemblies (**Ref. #9 & 9a**). **With the cable loop down and the angle toward the inside, place that end toward the winch end of the lift** and fasten the angle to the bed cross tube with a 1/2" x 3 1/2" bolts, washers, and nuts (**Ref. #20, 24 & 23**). Repeat procedure for the other end. Place the cable loops into the cutout holes of the bottom tube of the side members and secure each with a 1/2" x 5" galvanized steel bolt and 1/2" galvanized nut (**Ref. #33, & 35**). On the other end of the lift place the cable loops of the double cable top bed cross tube into the holes of the bottom tube of the side member. Align the loop with the first single hole and secure in place with 1/2" x 5 1/2" galvanized bolt and 1/2" galvanized nut (**Ref. #34 & 35**). Using a tape measure square the corners of the lift to within 1/4" or less. Tighten all bolts at this time.

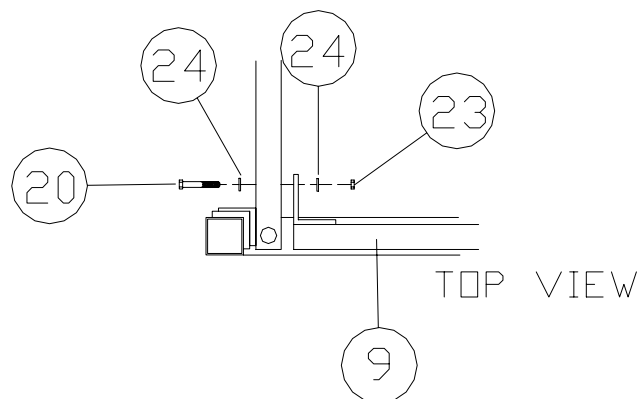
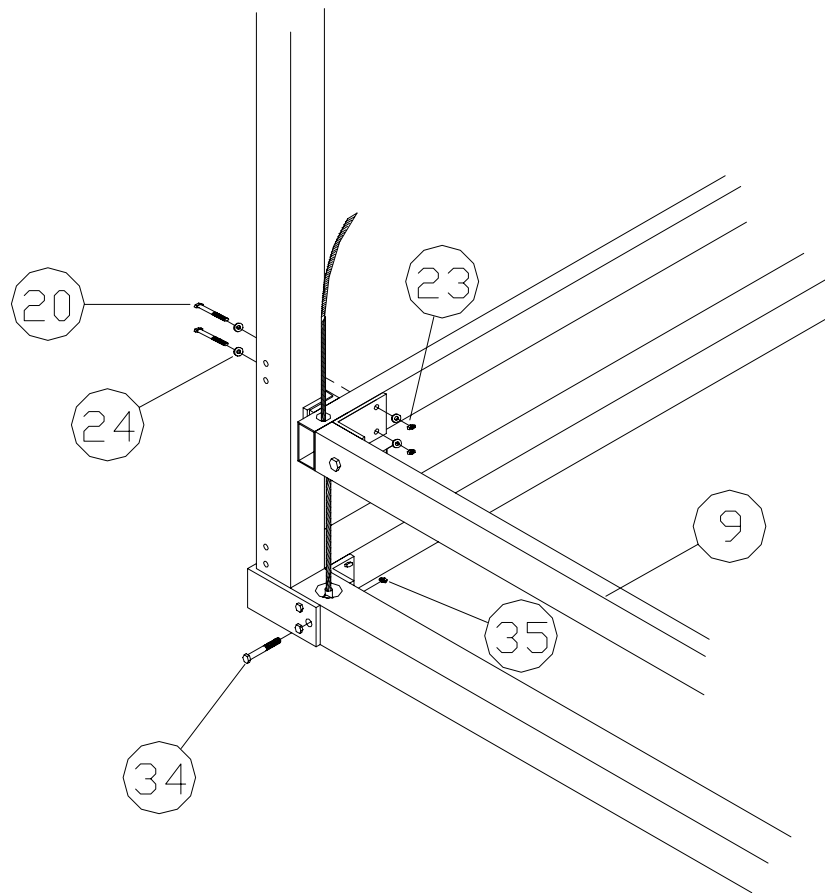

Step 7. Take the winch nut, washer and plastic shipping collar off the winch shaft. If possible lubricate the winch shaft with a light lubricant. Thread on lift wheel (**Ref. #11**) and replace washer and nut. Tighten acorn nut onto the winch shaft. There will be roughly an 1/8" clearance between the winch washer and the winch wheel. Turn the wheel clockwise until the cable pocket that is welded to the inside of the left side of the winch drum is toward the front of the winch. Take the plain end of the winch cable and bring it up through the backside of the winch drum and down into the cable pocket with about 3/4" of the cable protruding from the pocket. Locate the cable wedge (**Ref. #29**) and tap the narrow end of the wedge into the wide end of the pocket. Tap wedge with a hammer and punch until wedge is firmly secure in pocket.

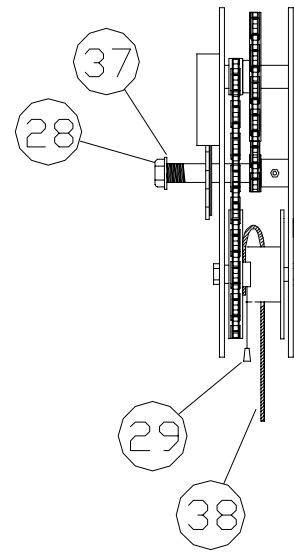

STEP 8. As a reference the corners are marked below on the assembly drawing. At corner B slide a rubber stop tube (**Ref. #16**) on to the cable. Fasten the cable stud to the top cross tube of the anchor side member using a 1/2" washer, and nut (**Ref. # 24 & 23**). At corner C slide a rubber stop tube on to the cable that is closest to the upright tube. Fasten both cable studs to the top cross tube of the anchor side member using the 1/4" x 3 3/8" x 6" cable support plate. Secure with 1/2" washers and nuts (**Ref. #21, 24 & 23**). At corner D slide a rubber stop tube on to the cable that is closest to the upright tube. Fasten both cable studs to the winch side member at the horizontal stub with 1/2" washers and nuts (**Ref. #24 & 23**). While standing on the double cable corner of the lift bed adjust the nuts on the cable studs until the cables have the same amount of tension and the bed is just off the angles on the bottom of the lift. Repeat procedure on the other double cable corner.

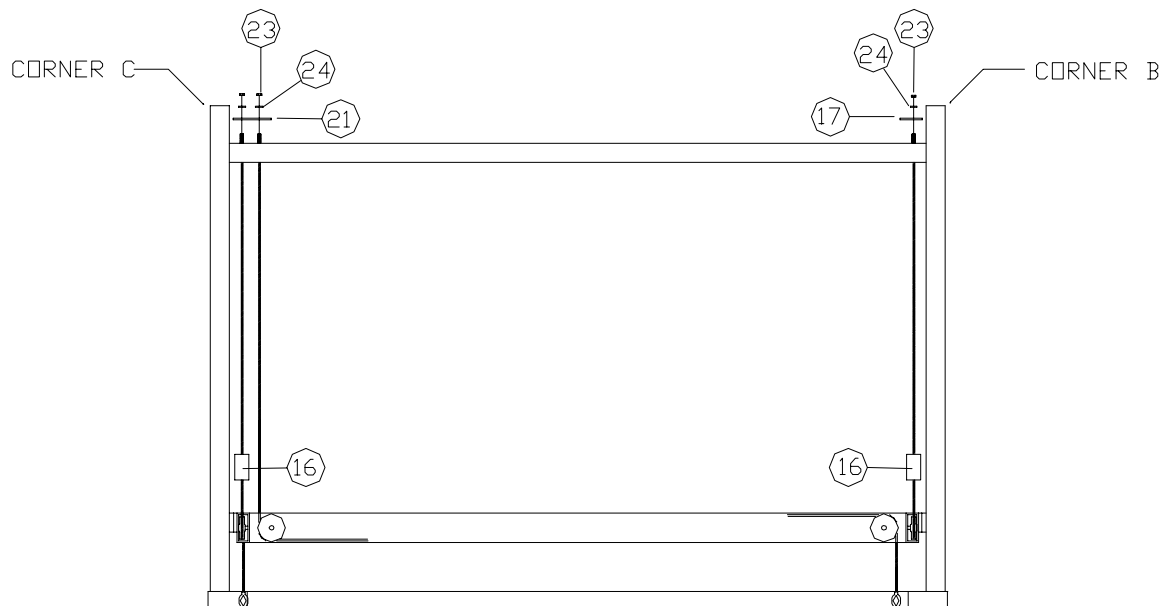
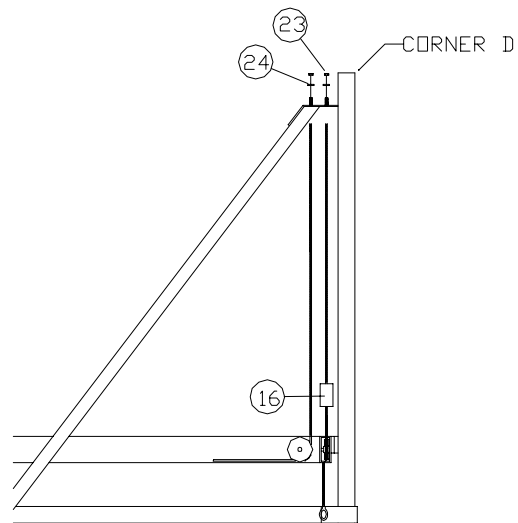

STEP 9. DPL

Raise the bed of the lift to working height. Find the four DPL bottom brackets and backer plates (**Ref. # 12 & 13**) and bolt to the bed of the lift as shown with the pocket facing the center of the lift using 1/2" X 3 1/2" bolts, washers, and nuts (**Ref. #20, 24, & 23**). Set according to inside width of pontoon floats and tighten nuts.

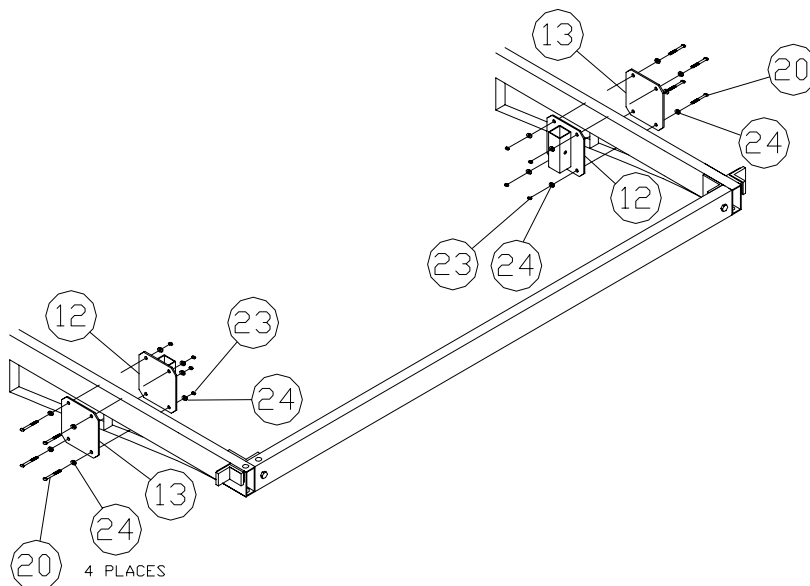

STEP 10. Locate the top rail bracket (angle with a tube in the center) (**Ref. # 42**) with the tube of the top bracket to the inside of the lift and the flat part of the angle to the outside, place the rail bracket into the tubes of the bottom mounting bracket. If you know the height of your pontoon floats set the brackets to the height where the floats will be just off the bed. Secure in place with 1/2" X 3 1/2" bolts and nuts (**Ref. #20 & 23**). Bolt the rail boards (**Ref. # 38**) to the side of the top rail bracket with 1/2" X 2 1/2" carriage bolts, washers, and nuts (**Ref. #26, 24, & 23**). Have the 45 degree cut end of the rail board toward the end of the lift where the back of the pontoon will be. Bolt the 2" X 4" skid boards (**Ref. # 39**) to the top of the top rail bracket using 1/2" X 2 1/2" carriage bolts, washers, and nuts (**Ref. # 26, 24, & 23**).

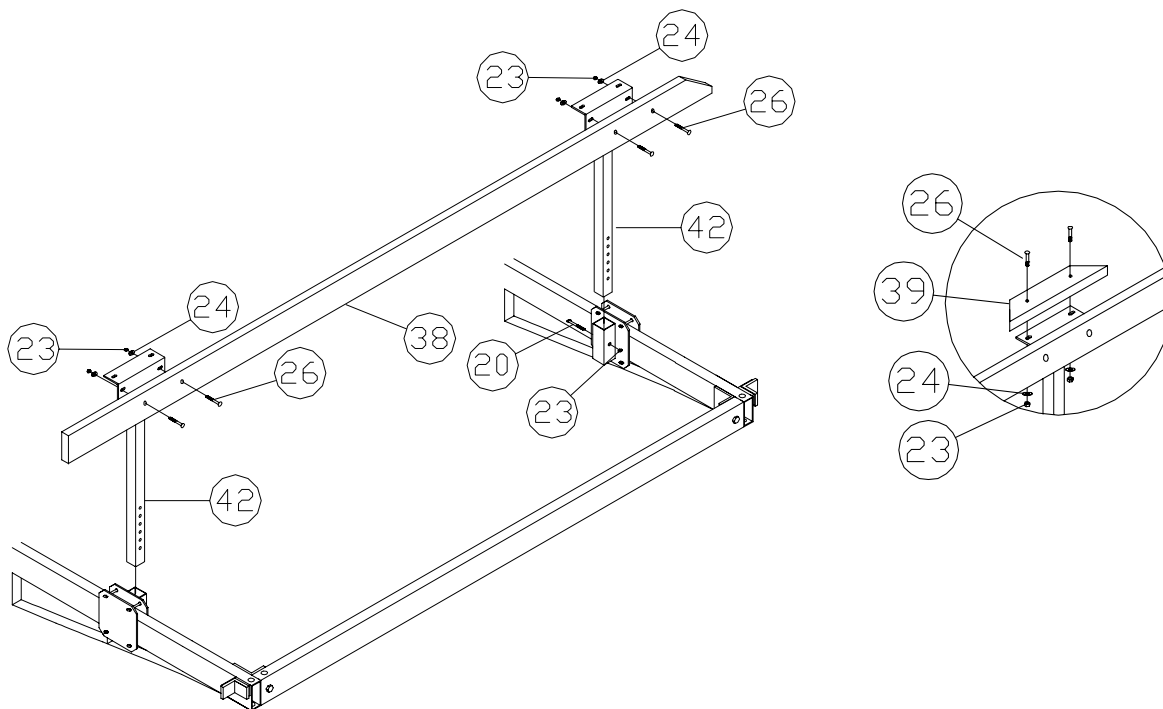

STEP 11. FPB

Raise the bed of the lift to working height. Find the four FPB bunk brackets and backer plates (Ref. # 40 & 41) and bolt to the bed of the lift as shown with the pockets facing the center of the lift using 1/2" X 3 1/2" bolts, washers, and nuts (Ref. # 20, 24, & 23). Set to desired width and secure.

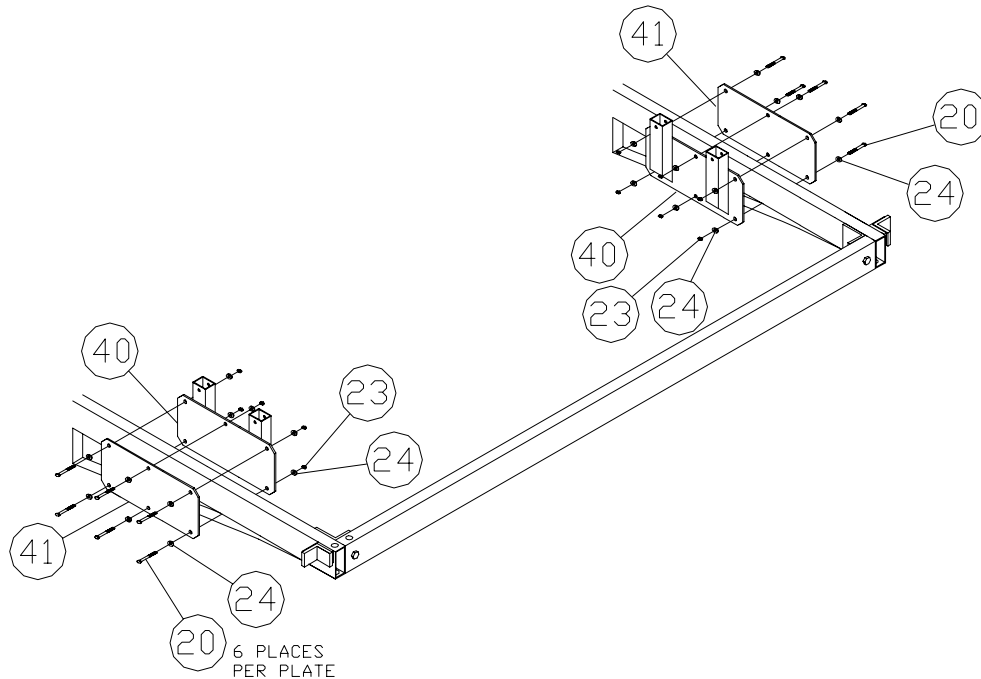

STEP 12. Place the bunk (Ref. # 14) on the uprights, with the tapered end toward the end of the lift where the back of the pontoon will be. Secure with 1/2" X 3 1/2" bolts, washers, and lock nuts (Ref. # 20, 24, & 44). Tip bunks inward slightly and tighten bolts so that the bunks will not turn freely but can pivot when weight is applied.

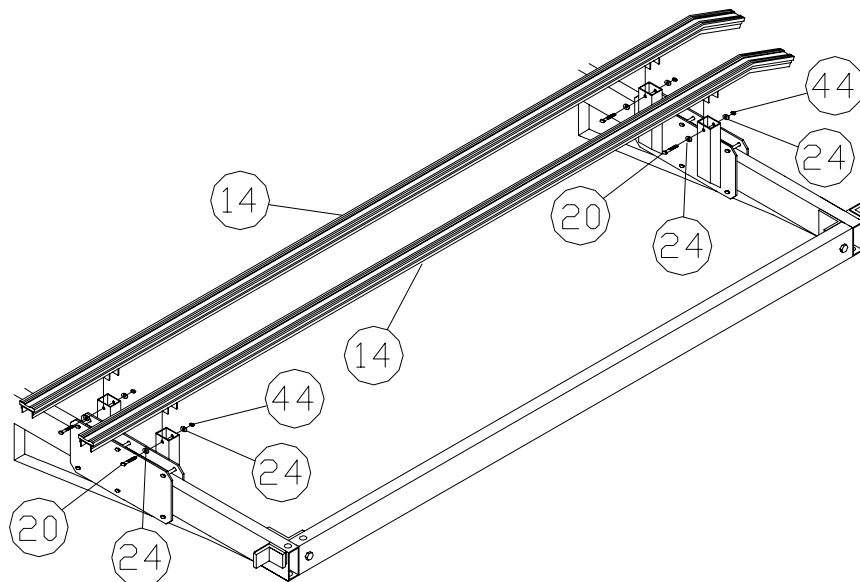

STEP 13. Raise and lower the lift a couple of feet a few times with weight on it to see if lift is coming up evenly. If lift is coming up uneven, either tighten or loosen nuts on cable studs. Example: if opposite end of the winch is more than an inch lower than the winch end remove weight from lift. Tighten the four nuts on the cable stud about 1" so that the cables have about the same tension. Reload and check again. When the boat is on the lift, there should be about the same tension on each cable.

PARTS LIST

256A 50120V DPL VERTICAL LIFT CHAIN DRIVE WINCH

255A 50120V FPB VERTICAL LIFT CHAIN DRIVE WINCH

REF. #	PART #	DESCRIPTION	256A QTY	255A QTY
1	69H	50120 SIDE WINCH SIDE	1	1
2	68H	50120 SIDE ANCHOR SIDE	1	1
3	1965	50120 LEVELING LEG 32"	4	4
4	1968	50120 LEVELING LEG FOOT PAD	4	4
5	50600	WINCH MOUNTING TUBE 26"	1	1
6	74H	50120 FRONT & REAR BOTTOM CROSS BAR	2	2
7	72H	50120 BED CROSS TB SINGLE CABLE	1	1
8	73H	50120 BED CROSS TB DBL CABLE	1	1
9	48H	50120 TOP BED/SIDE TB ASSEMBLY-RIGHT	1	1
9A	47H	50120 TOP BED/SIDE TB ASSEMBLY-LEFT	1	1
10	3025	WINCH CHAIN DRIVE 15:1	1	1
11	45F	LIFT WHEEL	1	1
12	18Q	BUNK BRACKET 50120V	4	-
13	30810	BUNK BRACKET BACKER PLATE 50120V	4	-
14	98C	50120 FLB BUNK W/PAD	-	4
16	4513	50120 RUBBER STOP 4"	3	3
17	80112	CABLE SUPPORT PLATE WINCH 1/4" X 3 3/8 X 3 3/8"	1	1
18	5114	BOLT 1/2" X 5" GR 2	5	5
19	5115	BOLT 1/2" X 5 1/2" GR 2	16	16
20	5121	BOLT 1/2" X 3 1/2" GR 2	28	40
21	80114	CABLE SUPPORT PLATE 1/4" X 3 3/8" X 6"	1	1
22	5087	BOLT 3/8" X 4 1/2"	2	2
23	5058	NUT FIN 1/2"	70	82
24	5071	WASHER 1/2"	69	85
25	5067	FENDER WASHER 3/8"	2	2
26	5208	BOLT 1/2" X 2 1/2" CARRIAGE	16	-
27	5056	NUT 3/8"	2	2
28	3027	WINCH NUT	1	1
29	3007	WINCH CABLE WEDGE	1	1
30	5218	LEG PIN 1/2 X 5" 5000	4	4
31	5092	HITCH PIN 1/8"	4	4
33	5223	BOLT GALV 1/2" X 5"	2	2
34	5224	BOLT GALV 1/2" X 5 1/2"	2	2
35	5052	NUT 1/2" GALV	4	4
37	5072	WINCH NUT WASHER 5/8"	1	1
38	50210	WOOD RAIL DPL 50120	2	-
39	50701	2" X 4" SKID BOARD	4	-
40	15Q	BUNK BRACKET FPB 50120V	-	4
41	30808	BUNK BRACKET FPB BACKER PLATE 50120V	-	4
42	19Q	PONTOON RAIL TOP BRACKET 50120V	4	-
44	5039	LOCKNUT 1/2"	-	8

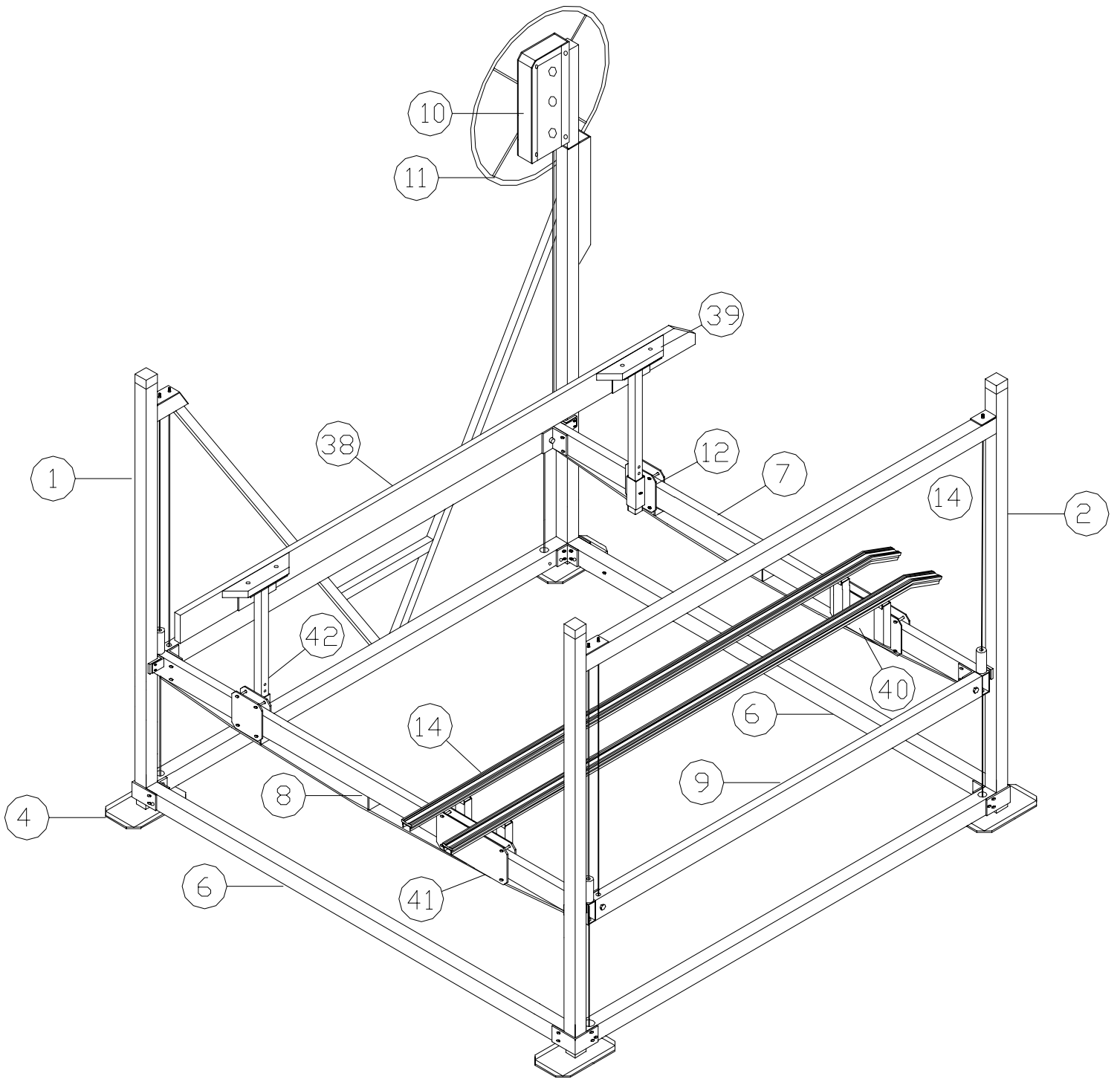

50120V TOP BED ASSEMBLY

Ref. no.	Part no.	Description	Qty
48	70H	5000 Winch Bed Cross Tube	1
49	71H	5000 Anchor Bed Cross Tube	1
50	0957	5000 Side Bed Tube Left	1
51	1970	5000 Side Bed Tube Right	1
52	3298	5.25" Pulley Idler	2
53	3230	5.25" Pulley Double	2
54	3316	4" Single Pulley	4
55	5092	Hitch Pin .125"	8
56	1962	Cable 5/16" x 204.75" Loop/Stud	2
57	3117	Cable SS 5/16" x 201" Loop/Stud	2
58	1963	Cable Galv. 3/8" x 302" W/Stud	1
59	1957	Shaft SS 3/4" x 2 5/8" (drilled)	4
60	5045	Clevis Pin SS 5/8" X 2 1/2"	4
61	4994	Machine Flat Head 1/4" X 7/8" Screw	8
62	5053	Locknut 1/4" Keps	8
63	50095	Plastic Slide Angle 3" X 3" X 2 3/4" UHMW	4
64	50326	End Cap 50102V	4
65	5159	Screw #8 X 3/4"	4

50120V SIDE BED TUBE LEFT AND RIGHT

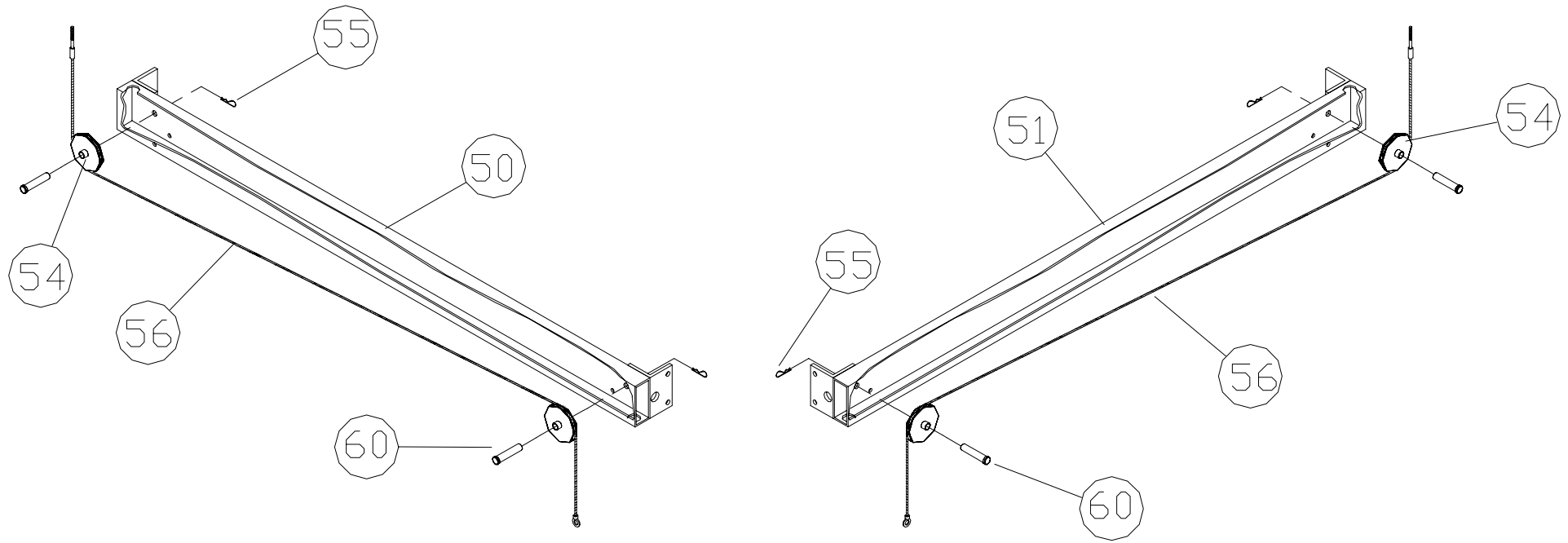

50120V WINCH & ANCHOR CROSS TUBE

