

**45A APL /47A DPL /267A FPB 40113V**  
**238A APL /239A DPL /279A FPB 40120V**  
**ALUMINUM VERTICAL 4000 LB PONTOON LIFT**

**Thank you for purchasing our product!**

**\*Please read these instructions and follow them step by step.\***

**STEP 1.** Separate and group like parts and fasteners together. Locate the winch side member with the longer upright tube and diagonal braces (**Ref. # 1**). Lay this side member on it's side with the corner angles up. Locate the chain drive winch (**Ref. # 3**). And remove the outside guard. Slide the winch onto the longer upright tube of the winch side member making sure the winch hub is down. Bolt the ears of the winch together with 3/8" x 4 1/2" bolts, washers, and nuts (**Ref. # 18, 16, 19**) making sure the top hole in the winch is lined up with the hole in the upright tube. Tighten the bolts in the ears at this time. If installing a canopy, place the canopy mounting bracket into the upright tube (see canopy instructions). Finish mounting the winch to the upright by placing a 3/8" washer (**Ref. # 16**) against the top hole in the winch and two larger fender washers (**Ref. # 15**) against the top hole on the tube side. Secure in place with a 3/8" x 4 1/2" bolt and nut (**Ref. # 18 & 19**).

If not installing a canopy, place a square plastic cap (**REF. # 41**) on to the top of the other upright tube. Slide the leveling legs (**REF. # 4**) into the side member uprights. Secure in place with 1/2" x 1" set screws (**REF. # 17**).

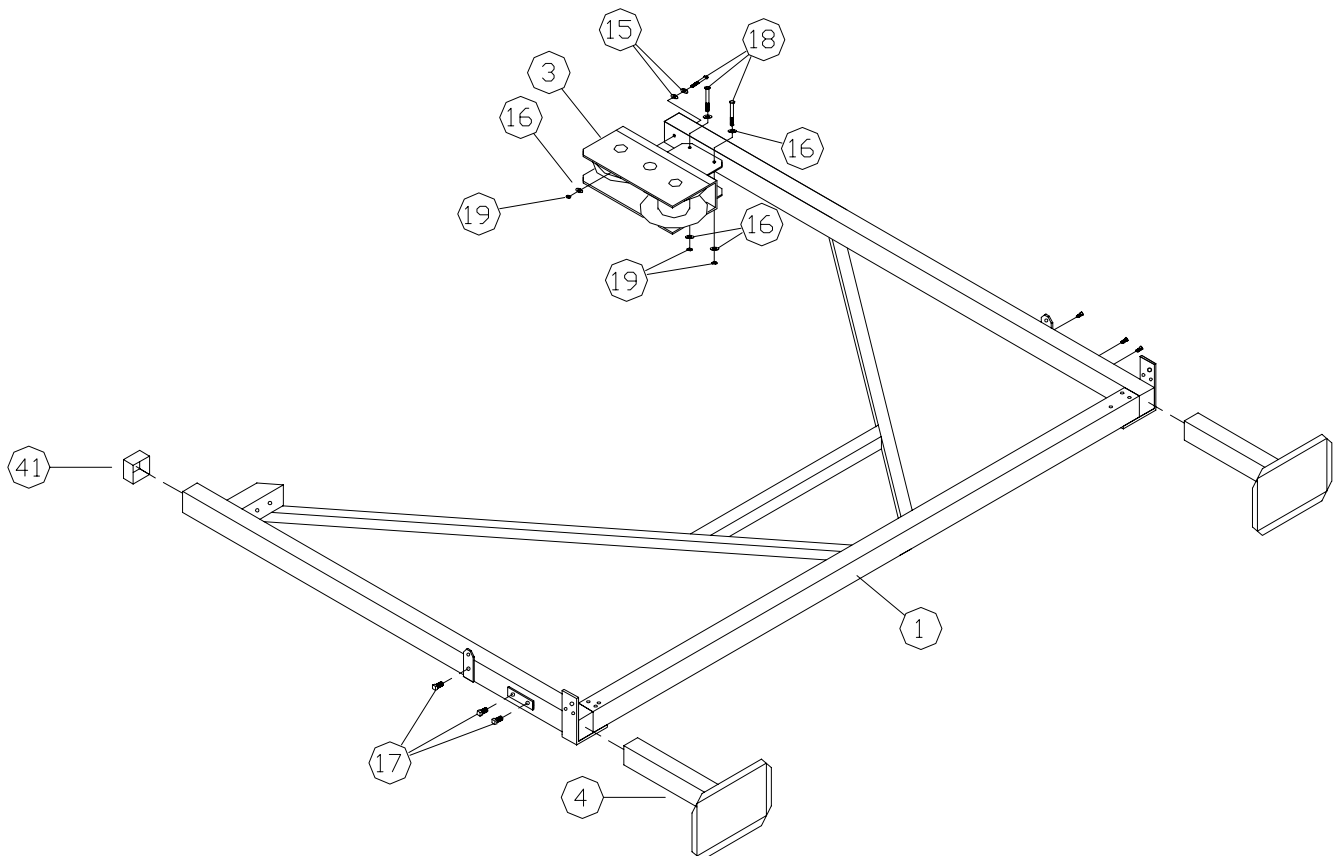

**STEP 2.** Locate the two 3 1/2" x 3 1/2" x 112 1/2" bottom cross tubes (**REF. # 5**) Using two people stand the side member up on it's leveling legs. With one person balancing the side member, bolt the bottoms cross tube to the corner angles using 3/8" x 5" bolts, washers & nuts. (**REF. # 37, 16 & 19**). Leave nuts finger tight.

**STEP 3.** Place leveling legs (**REF. # 4**) into the anchor side member (**REF. # 2**) and secure in place with 1/2" x 1" set screws. Bolt anchor side member up to the ends of the bottom cross tube as done with winch side member. Leave nuts finger tight.

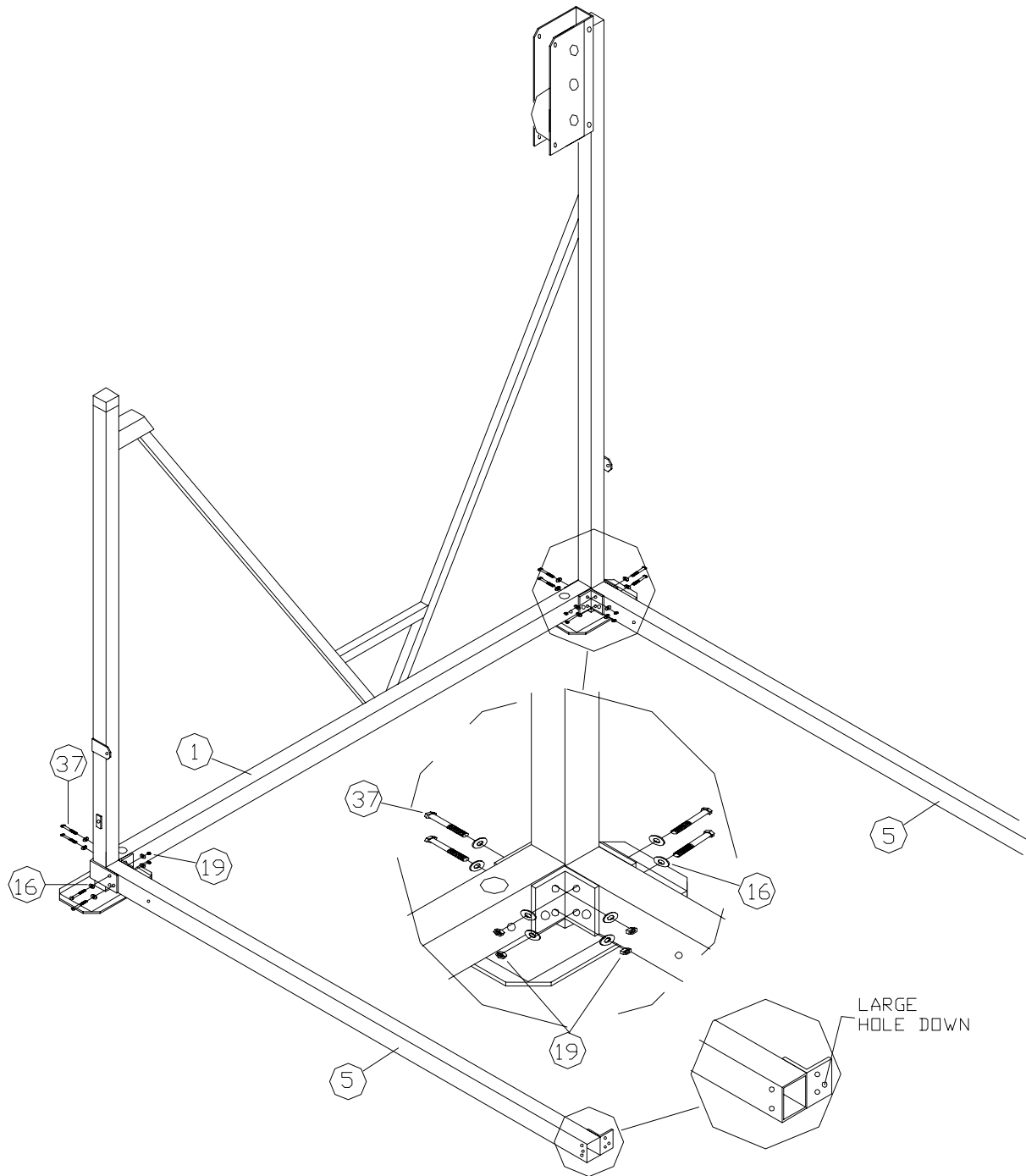

**STEP 4.** Locate the two 2" x 4 3/4" x 117 1/2" top bed cross tubes. The tube with a single cable protruding from each end is the winch bed cross tube. (**REF. # 6**). The other one with the two cables on each end is the anchor cross tube (**REF. # 7**). From the inside of the lift frame, on the winch end, place the winch bed cross tube across the end of the lift, so that the nylon slide angles are up against the inside corners of the side member upright tubes. Take the anchor cross bed tube and place across the other end of the lift frame so that the bottom loops of the cable are in the cutout holes of the bottom side tube of the side members and the nylon slide angles are against the uprights as on the other bed cross tube.

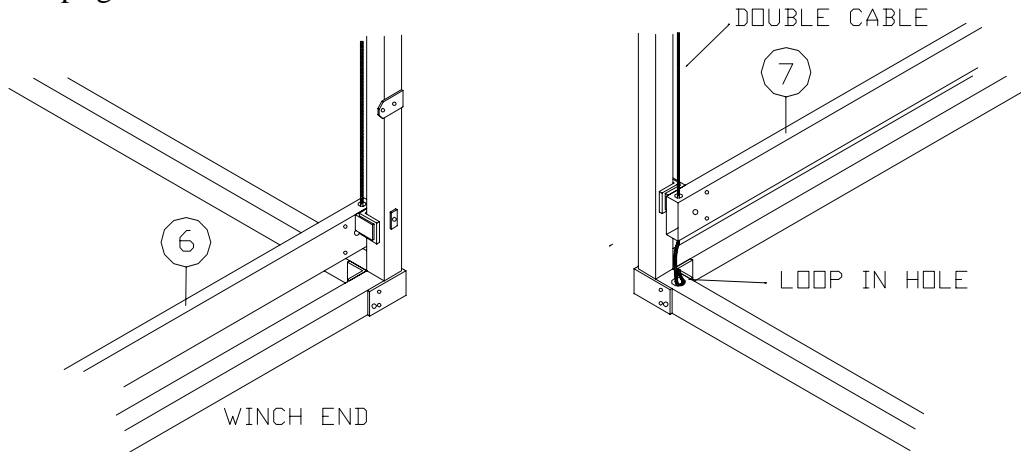

**STEP 5.** Assembly may be easier if 2" x 4" 's are laid diagonally on end across the bottom four corners of the lift and the bed is assembled on top of the 2" x 4" 's. Take the two 2" x 4 3/4" x 104" side bed tube cable assembly tubes (**REF. # 8 & 9**). With the cable loop end down and toward the winch end of the lift, fasten the end of the side rail tube to the two holes in the bed cross tubes with 3/8" x 3" bolts, washers & nuts (**REF. # 20, 16 & 19**). Place cable loops into the cutout holes of the bottom tube of the side members. Secure in place with 1/2" x 4" galvanized bolts, & nuts. (**REF. # 38 & 40**) Secure the cable loops of the anchor bed cross tubes, on the other end of the lift with a 1/2" x 5" galvanized bolts, & nuts. (**REF. # 39, & 40**). Using a tape measure, square the corners to within 1/4" or less. Tighten all bolts at this time.

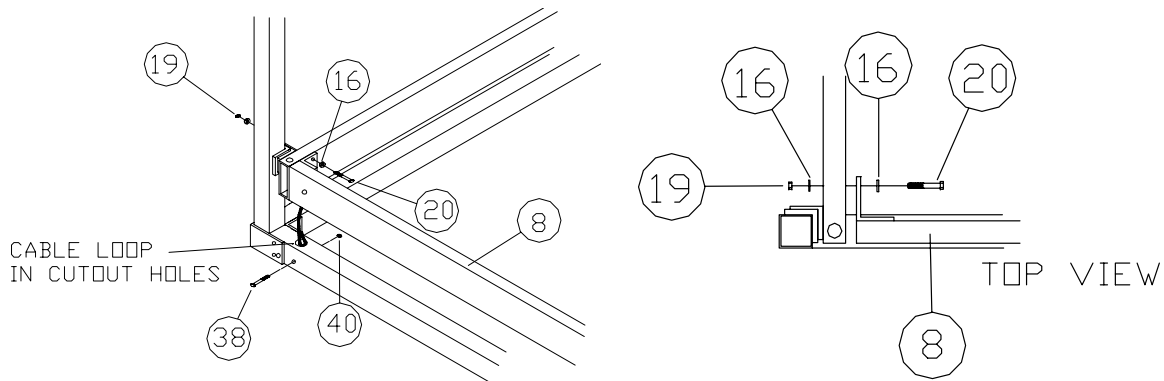

**STEP 6.** Take the winch nut, washer (**REF. # 25 & 27**) and plastic shipping collar off the winch shaft, if possible lubricate the winch shaft with a light lubricant. Thread on winch wheel (**REF # 10**) and replace washer and nut. Tighten winch acorn nut onto the winch shaft. There will be roughly 1/8" clearance between the winch washer and the winch wheel. Turn the wheel clockwise until the pocket that is welded to the inside of the left side of the winch drum is toward the front edge of the winch. Take the plain end of the winch cable and bring it up through the backside of the winch drum, down and through the pocket on the inside of the drum. Take the cable wedge (taped to the side of the winch) and from the end pound the wedge into the pocket until tight.

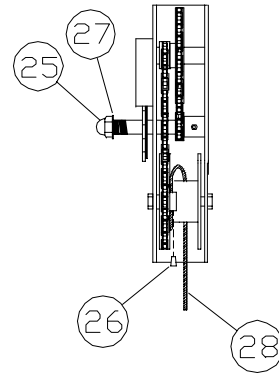

**STEP 7.** As a reference the corners are marked below on the assembly drawing. At corner B slide a rubber stop tube (**REF. # 11**) on to the cable. Fasten the cable stud to the top cross tube of the anchor side member using the 1/4" x 3" x 3" cable support plate, 1/2" washer, and nut (**REF. # 21, 22 & 31**). At corner C slide a rubber stop tube on to the cable that is closest to the upright tube. Fasten both cable studs to the top cross tube of the anchor side member using 1/4" x 3" x 6" cable support plate. Secure with 3/8 washers and nuts (**REF. # 23, 16 & 19**). At corner D slide a rubber stop tube on to the cable that is closest to the upright tube. Fasten both cable studs to the winch side member at the horizontal stub with 3/8" washers and nuts (**REF. # 16 & 19**). While standing on the double cable studs until the cables have the same amount of tension and the bed is just off the 2" x 4" 's. Repeat procedure on the other double cable corner.

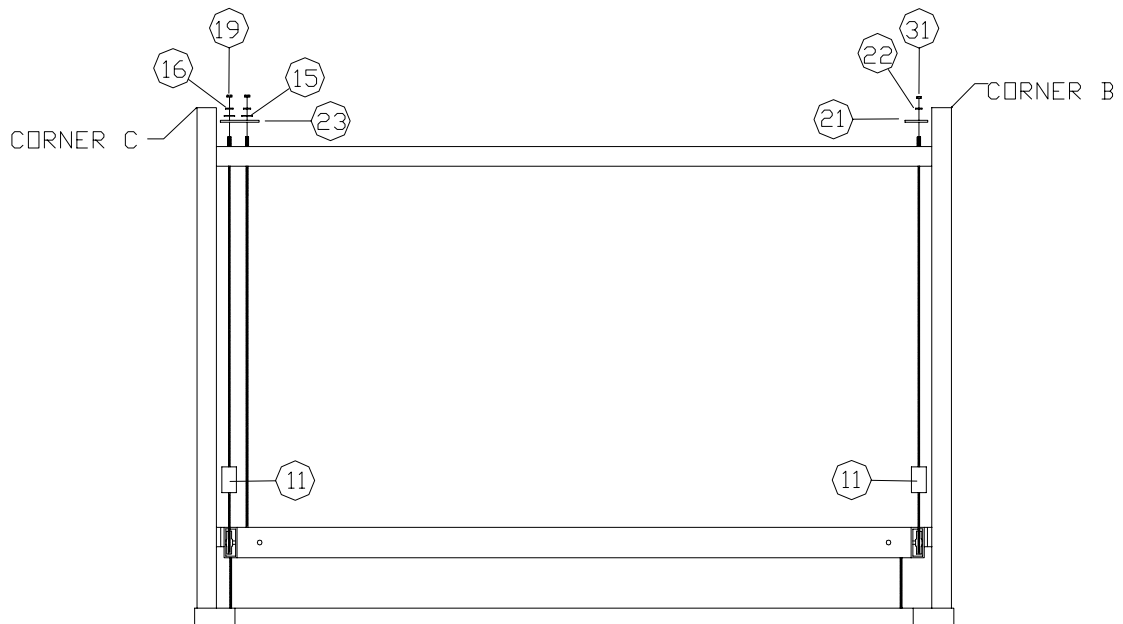
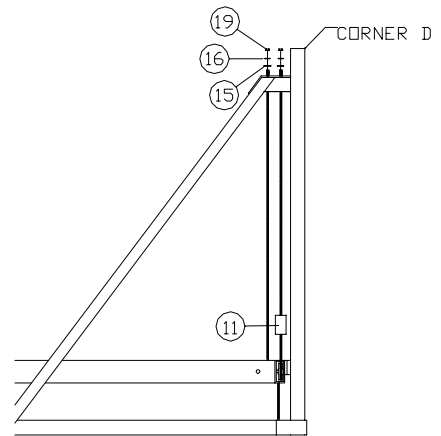

**STEP 8.** Bolt the four diagonal braces (**REF. # 29**) into the four bottom corners of the lift by placing a 3/8" x 4 1/2" bolt and washer (**REF. # 18 & 16**) thru the round hole of the brace and into the hole of the bottom cross tube. Finger tighten with washer & nut (**REF. # 16 & 19**). Place a 3/8" x 1" bolt and washer (**REF. # 30 & 16**) thru the slotted hole of the brace into the tab of the upright tube. Tighten bottom bolts at this time. Check to see if the side upright tubes are parallel with each other. Adjust if necessary by pushing in or pulling out on the tube. When adjusted correctly, tighten the top bolts of braces.

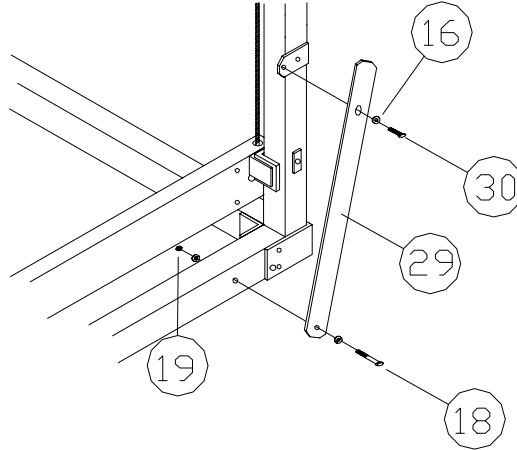

## APL

**STEP 9.** Raise bed off lift to working height. Place the four bed members (**REF. # 12**) over the bed cross tubes so that the holes that are in the farthest from the end of the bed members are toward the outside of the lift and most of the bed member is offset toward the center of the lift. Fasten in place by placing a backer plate (**REF. # 14**) thru the bed member and backer plate. Secure with 3/8" washer and nut (**REF. # 16 & 19**).

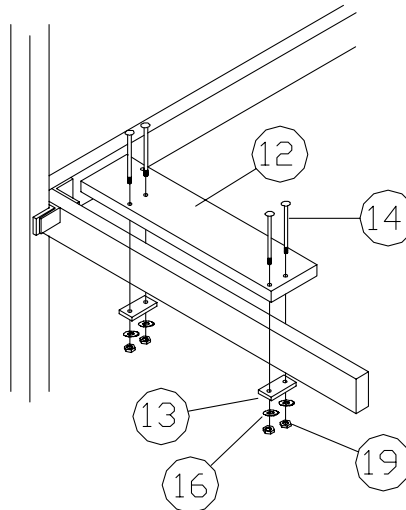

## DPL

**STEP 10.** Find the four bottom mounting brackets (large channel with an upright tube in the center) (**REF. # 32**). Set the bottom brackets over the top cross tubes of the lift. Place 3/8" x 3" bolts, washers and nuts (**REF. # 20, 16 & 19**) into the bottom holes. Set according to inside width of pontoon floats and tighten nuts.

Locate the top rail bracket (angle with a tube in the center) (**REF. # 33**) with the tube of the top bracket to the inside of the lift and the flat part of the angle to the outside, place the rail bracket into the tubes of the bottom mounting bracket.

Bolt the long 2" x 8" x 14' rail boards (**REF. # 34**) to the side of the top rail bracket with 3/8" x 2 1/2" carriage bolts, washers and nuts (**REF. # 36, 16 & 19**). Have the 45 degree cut end of the rail board to the back of the lift. Bolt the four 2" x 4" skid boards (**REF. # 35**) to the top of the top rail bracket using 3/8" x 2 1/2" carriage bolts.

Place the 1/2" x 1" set screws (**REF. # 17**) into the bottom mounting brackets. Set to height (usually 1" to 2" higher than the pontoon floats) and tighten set screws.

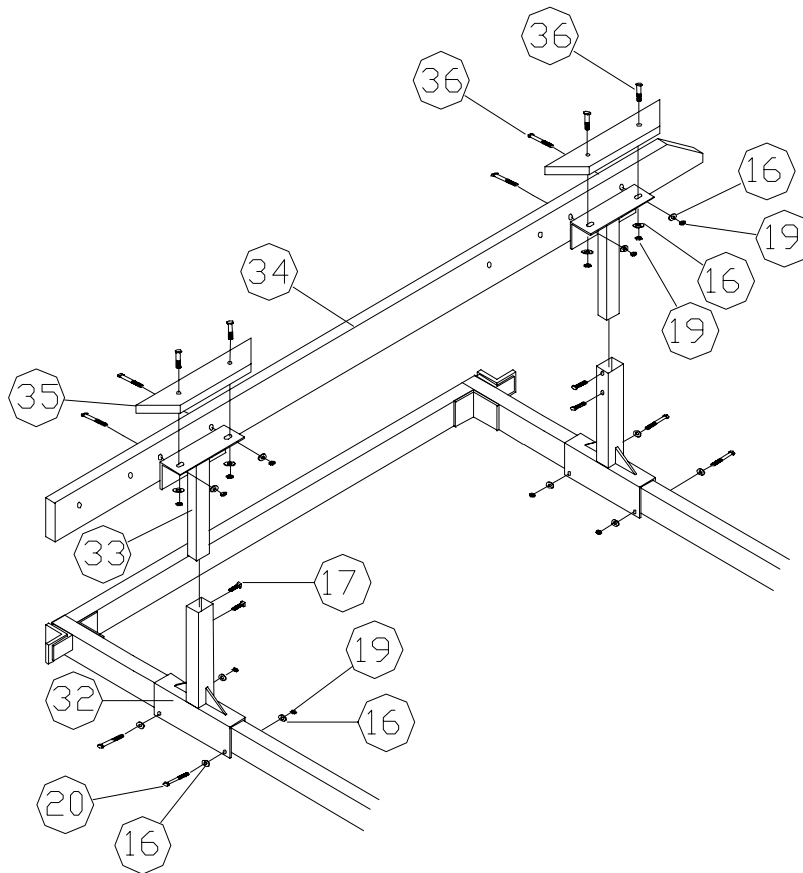

## FPB

**STEP 11.** Raise the bed of the lift to working height. Set the bunk brackets (**REF. # 42**) over the front and rear cross bars of the lifts bed with the pockets toward the center of the lift. Set to desired width and secure with 3/8" X 3" bolts, washers and nuts (**REF. # 20, 16 & 19**). **NOTE:** It may be necessary to use only the center hole, or the center hole and one of the outside holes if the truss is in the way.

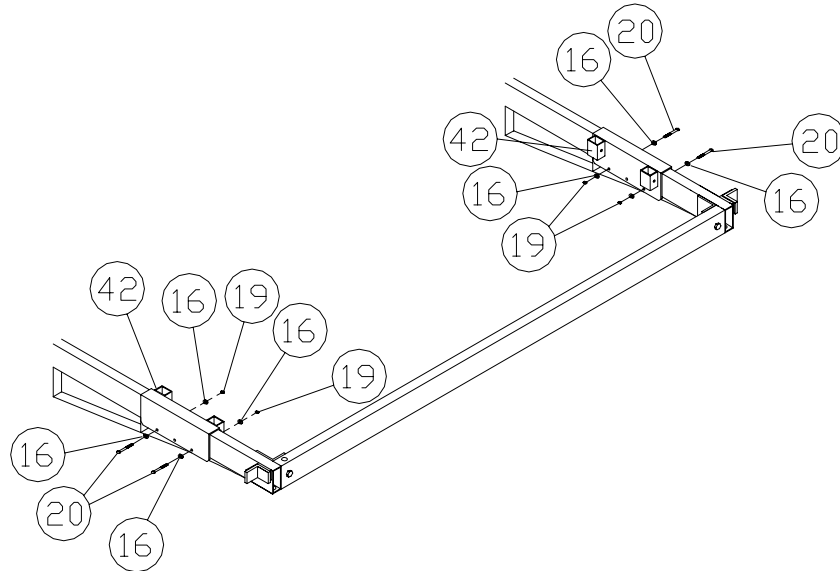

**STEP 12.** Place the bunk uprights (**REF. # 45**) into the pockets and secure with 3/8" X 3" bolts and nuts (**REF. # 20 & 19**). Place the bunk (**REF. # 43**) on the uprights with the tapered end toward the back of the lift. Secure with 3/8" X 2 1/2" bolts and lock nuts (**REF. # 44 & 24**). Tip bunks inward slightly and tighten bolts so that the bunks will not turn freely but can pivot when weight is applied.

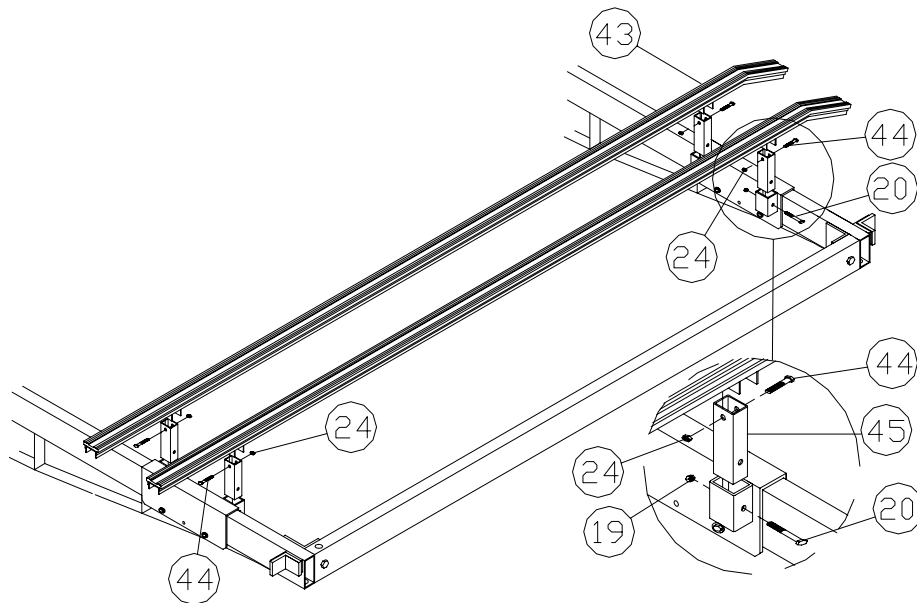

**STEP 13.** When placing lift in the lake, you must level the lift as close as possible for the lift to operate correctly. When tightening your set screws, finger tighten until tight and then tighten 2 1/2 to 3 1/2 turns after you start feeling resistance with a wrench. When raising your boat, check and see if the bed is rising evenly and that all cables have about the same tension. If lift bed is coming up crooked, check lift for levelness, if lift is level, remove boat and adjust cable nuts to level bed.

02/04/04

U:\JUDY\INSTR 2002 LIFTS\LIFT INST 40113V/40120V APL/DPL/FPB.doc

PAGE 8 OF 12

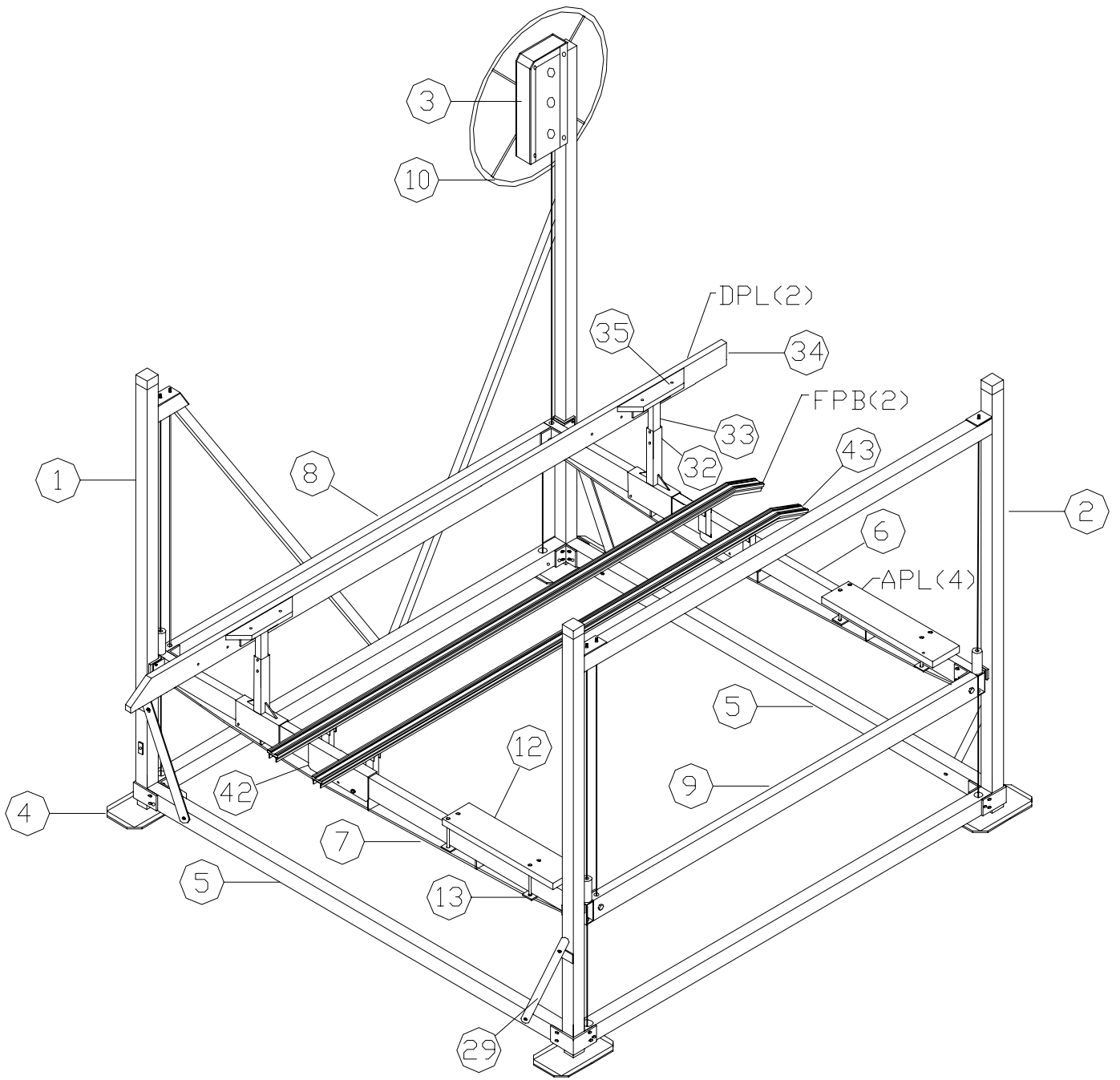

**PARTS LIST**  
**45A/47A 40113V & 238A/239A 40120V APL/DPL**

<b>REF. #</b>	<b>PART #</b>	<b>DESCRIPTION</b>	<b>45A APL</b>	<b>47A DPL</b>	<b>238A APL</b>	<b>239A DPL</b>	<b>267A FPB</b>	<b>279A FPB</b>
1	51H	SIDE MEMBER WINCH 40113V	1	1	-	-	1	-
	63H	SIDE MEMBER WINCH 40120V	-	-	1	1	-	1
2	52H	SIDE MEMBER ANCHOR 40113V	1	1	-	-	1	-
	64H	SIDE MEMBER ANCHOR 40120V			1	1	-	1
3	3H	WINCH 3026 W/PLATE	1	1	1	1	1	1
4	58H	LEVELING LEG	4	4	4	4	4	4
5	53H	BOTTOM CROSS TUBE 40113V	2	2	-	-	2	-
	67H	BOTTOM CROSS TUBE 40120V	-	-	2	2	-	2
6	55H	WINCH END BED CROSS TUBE 40113V	1	1	-	-	1	-
	66H	WINCH END BED CROSS TUBE 40120V	-	-	1	1	-	1
7	57H	ANCHOR CROSS TUBE 40113V	1	1	-	-	1	-
	65H	ANCHOR CROSS TUBE 40120V	-	-	1	1	-	1
8	45H	SIDE BED TUBE RIGHT 40113V	1	1	-	-	1	-
	37H	SIDE BED TUBE RIGHT 40120V	-	-	1	1	-	1
9	44H	SIDE BED TUBE LEFT 40113V	1	1	-	-	1	-
	38H	SIDE BED TUBE LEFT 40120V	-	-	1	1	-	-
10	45F	LIFT WHEEL	1	1	1	1	1	1
11	4513	RUBBER STOP 4"	3	3	3	3	3	3
12	50059	BED MEMBER	4	-	4	-	-	-
13	50144	BED MEMBER BACKER PLATE	8	-	8	-	-	-
14	5186	CARRIAGE BOLT 3/8" X 7 1/2"	16	-	16	-	-	-
15	5067	WASHER FENDER 3/8"	6	6	6	6	6	6
16	5070	WASHER 3/8"	92	108	92	108	92	92
17	5174	SET SCREW 1/2"	4	12	4	12	4	4
18	5087	BOLT 3/8" X 4 1/2"	7	7	7	7	7	7
19	5056	NUT 3/8"	58	74	58	74	57	57
20	5084	BOLT 3/8" X 3"	8	16	8	16	24	24
21	30005	WINCH CABLE SUPPORT PLATE 3" X 3"	1	1	1	1	1	1
22	5071	WASHER 1/2"	1	1	1	1	1	1
23	30007	CABLE SUPPORT PLATE 3" X 6"	1	1	1	1	1	1
24	5038	LOCKNUT 3/8"	4	4	4	4	8	8
25	3027	WINCH NUT	1	1	1	1	1	1
26	3007	CABLE WEDGE	1	1	1	1	1	1
27	5072	WINCH NUT WASHER 3/8"	1	1	1	1	1	1
29	30009	DIAGONAL BRACE	4	4	4	4	4	4
30	5091	BOLT 3/8" X 1 1/4"	4	4	4	4	4	4
31	5058	NUT 1/2"	5	5	5	5	5	5
32	11C	BOTTOM BRACKET	-	4	-	4	-	-
33	12C	TOP RAIL BRACKET	-	4	-	4	-	-
34	50200	RAIL	-	2	-	2	-	-
35	50201	SKID BOARD	-	4	-	4	-	-
36	5195	CARRIAGE BOLT 3/8" X 2 1/2"	-	16	-	16	-	-
37	5090	BOLT 3/8" X 5" GR 2	16	16	16	16	16	16
38	5222	BOLT GALV 1/2" X 4"	2	2	2	2	2	2
39	5223	BOLT GALV 1/2" X 5"	2	2	2	2	2	2
40	5052	NUT GALV 1/2" OVERSIZED	4	4	4	4	4	4
41	3824	CAP 3 1/2" SQUARE	3	3	3	3	3	3
42	48F	BUNK BRACKET DOUBLE FPB	-	-	-	-	4	4
43	65C	BUNK AND PAD 136.5"	-	-	-	-	4	-
43	87C	BUNK AND PAD 156"	-	-	-	-	-	4
44	5083	BOLT 3/8" X 2 1/2"	-	-	-	-	8	8
45	50335	BUNK UPRIGHT	-	-	-	-	8	8

## CHAIN WINCH MOUNTING INSTRUCTIONS

**STEP 1.** Because of the hole placement on the winch, it may be easier to remove the back mounting channel (**Ref. No. 2**) and bolt it to the inside of the lifts upright first and then re-bolt the winch assembly (**Ref. No. 4**) to the back mounting channel.

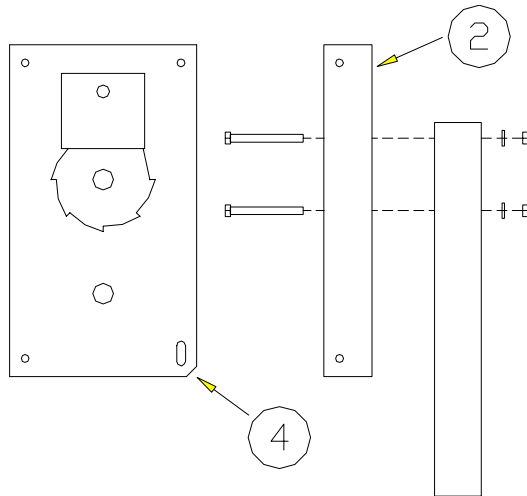

### 30113V/ 30120V & 40113V/40120V TOP BED ASSEMBLY PARTS LISTS

Ref.no.	Part no.	Description	30113V		40113V		
			30120V	40120V	30120V	40120V	
1.	20H	Side Bed Tube Left	30113V/40113V	1	-	1	-
	19H		30120V/40120V	-	1	-	1
2.	21H	Side Bed Tube Right	30113V/40113V	1	-	1	-
	18H		30120V/40120V	-	1	-	1
3.	40H	Winch End Bed Cross Tube Sgl Cable	30113V	1	-	-	-
	15H		30120V	-	1	-	-
	54H	Winch End Bed Cross Tube Sgl Cable	40113V	-	-	1	-
	10H		40120V	-	-	-	1
4.	41H	Anchor End Bed Cross Tube Dbl Cable	30113V	1	-	-	-
	16H		30120V	-	1	-	-
	56H	Anchor End Bed Cross Tube Dbl Cable	40113V	-	-	1	-
	11H		40120V	-	-	-	1
5.	3316	4" Nylon Single Pulley		2	2	2	2
6.	3317	4" Nylon Double Pulley		2	2	2	2
7.	5092	Hitch Pin 1/8"		2	2	2	2
8.	3042	Cable SS 1/4" x 177"		2	-	2	-
	3115	Cable SS 1/4" x 196 1/4"		-	2	-	2
9.	3041	Cable SS 1/4" x 191.5"		2	-	2	-
	3116	Cable SS 1/4" x 198 3/4"		-	2	-	2
10.	3114	Cable Galv. 5/16" x 290"		1	1	1	1
11.	5045	Clevis Pin SS .625" x 2.5"		2	2	2	2
12.	3827	Cap 2" x 4.7" End Cap Vertical Upright		2	2	2	2
13.	4994	Machine Flat Head 1/4" x 7/8" Screw		2	2	2	2
14.	5053	Locknut 1/4" Keps		2	2	2	2
15.	30016	Plastic Slide Angle .50" x 3" x 3" x 2.5" UHMW		2	2	2	2

# 3000V/4000V SIDE BED TUBE LEFT AND RIGHT

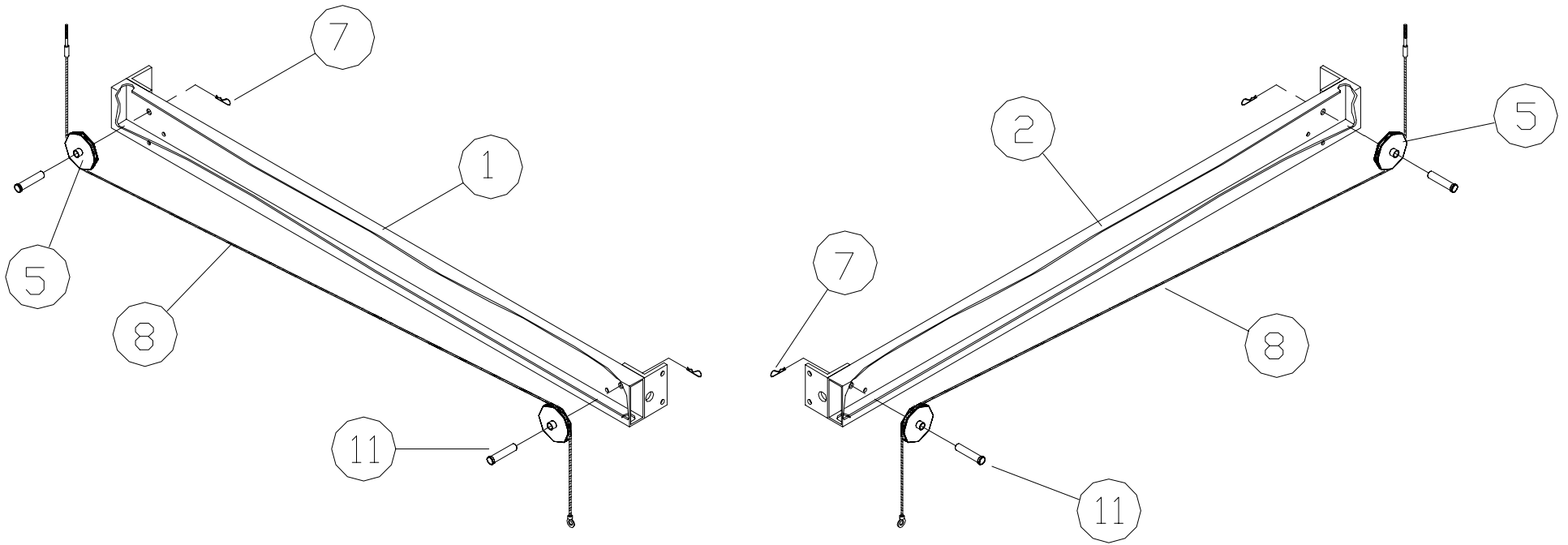

# 4000V WINCH & ANCHOR CROSS TUBE

