

37A APL /38A DPL /271A FPB 30113V
232A APL/233A DPL /276A FPB 30120V
ALUMINUM VERTICAL 3000 LB PONTOON LIFT

Thank you for purchasing our product!
***Please read these instructions and follow them step by step.**

STEP 1. Separate and group like parts and fasteners together. Locate the winch side member with the longer upright tube and diagonal braces (**Ref. # 1**). Lay this side member on it's side with the corner angles up. Locate the chain drive winch (**Ref. # 3**). And remove the outside guard. Slide the winch onto the longer upright tube of the winch side member making sure the winch hub is down. Bolt the ears of the winch together with 3/8" x 4" bolts, washers, and nuts (**Ref. # 37, 16, 19**) making sure the top hole in the winch is lined up with the hole in the upright tube. Tighten the bolts in the ears at this time. If installing a canopy, place the canopy mounting bracket into the upright tube (see canopy instructions). Finish mounting the winch to the upright by placing a 3/8" washer (**Ref. # 16**) against the top hole in the winch and two larger fender washers (**Ref. # 15**) against the top hole on the tube side. Secure in place with a 3/8" x 4" bolt and nut (**Ref. # 37 & 19**).

If not installing a canopy, place a square plastic cap (**Ref. # 42**) onto the top of the other upright tube. Slide the leveling legs (**Ref. # 4**) into the side member uprights. Secure in place with 1/2" x 1" set screws (**Ref. # 17**).

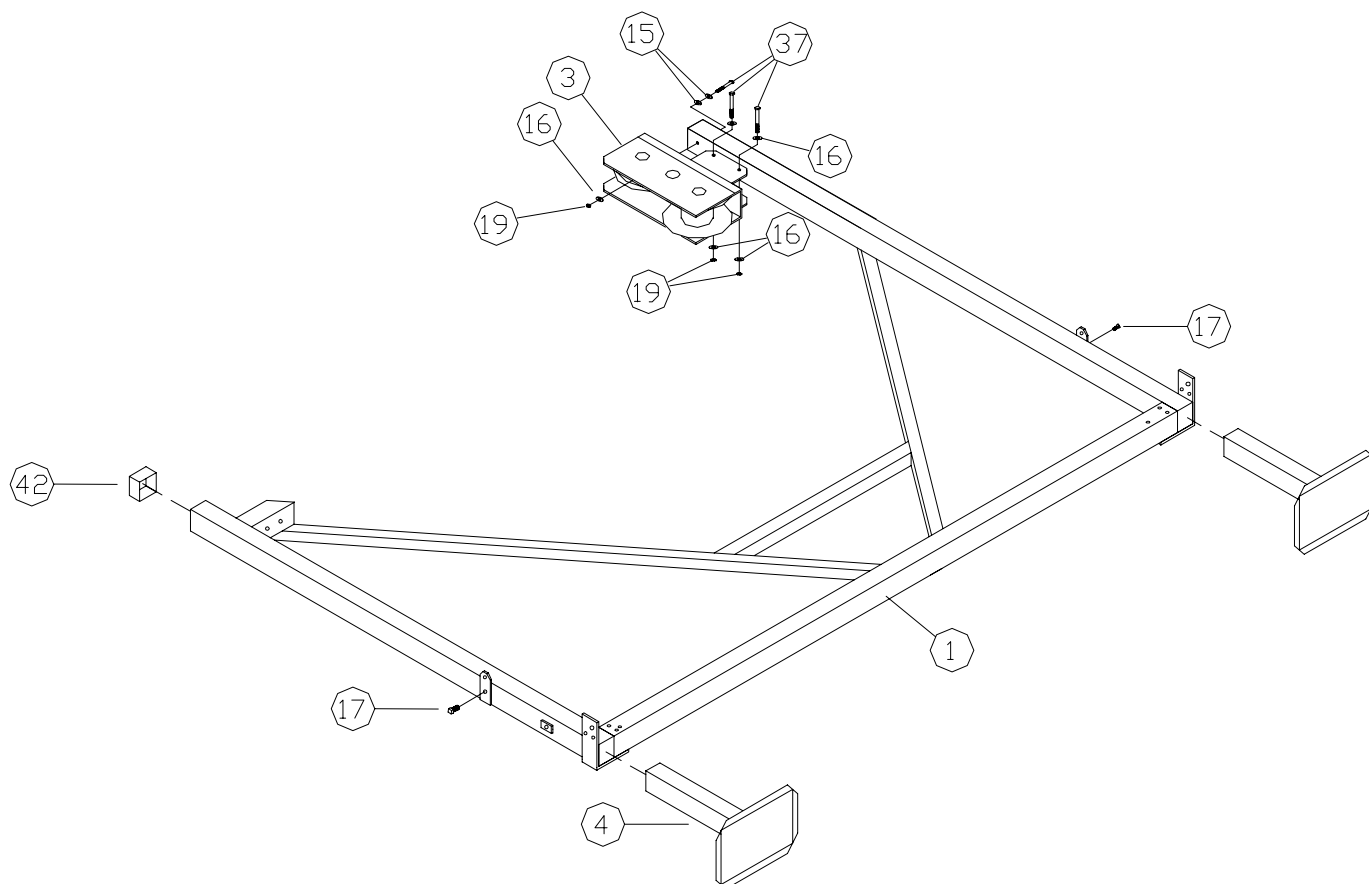

STEP 2. Locate the two 3" x 3" x 112 1/2" bottom cross tubes (**Ref. # 5**) Using two people stand the side member up on it's leveling legs. With one person balancing the side member, bolt the bottom cross tube to the corner angles using 3/8" x 4 1/2" bolts, washers & nuts. (**Ref. # 18, 16 & 19**). Leave nuts finger tight.

STEP 3. If not installing a canopy top place the remaining square plastic caps onto the tops of the upright tubes of the anchor side member. Place leveling legs (**Ref. # 4**) into the anchor side member (**Ref. # 2**) and secure in place with 1/2" x 1" set screws. Bolt anchor side member up to the ends of the bottom cross tube as done with winch side member. Leave nuts finger tight. Using a tape measure, square the corners to within 1/4" or less. Tighten all bolts at this time.

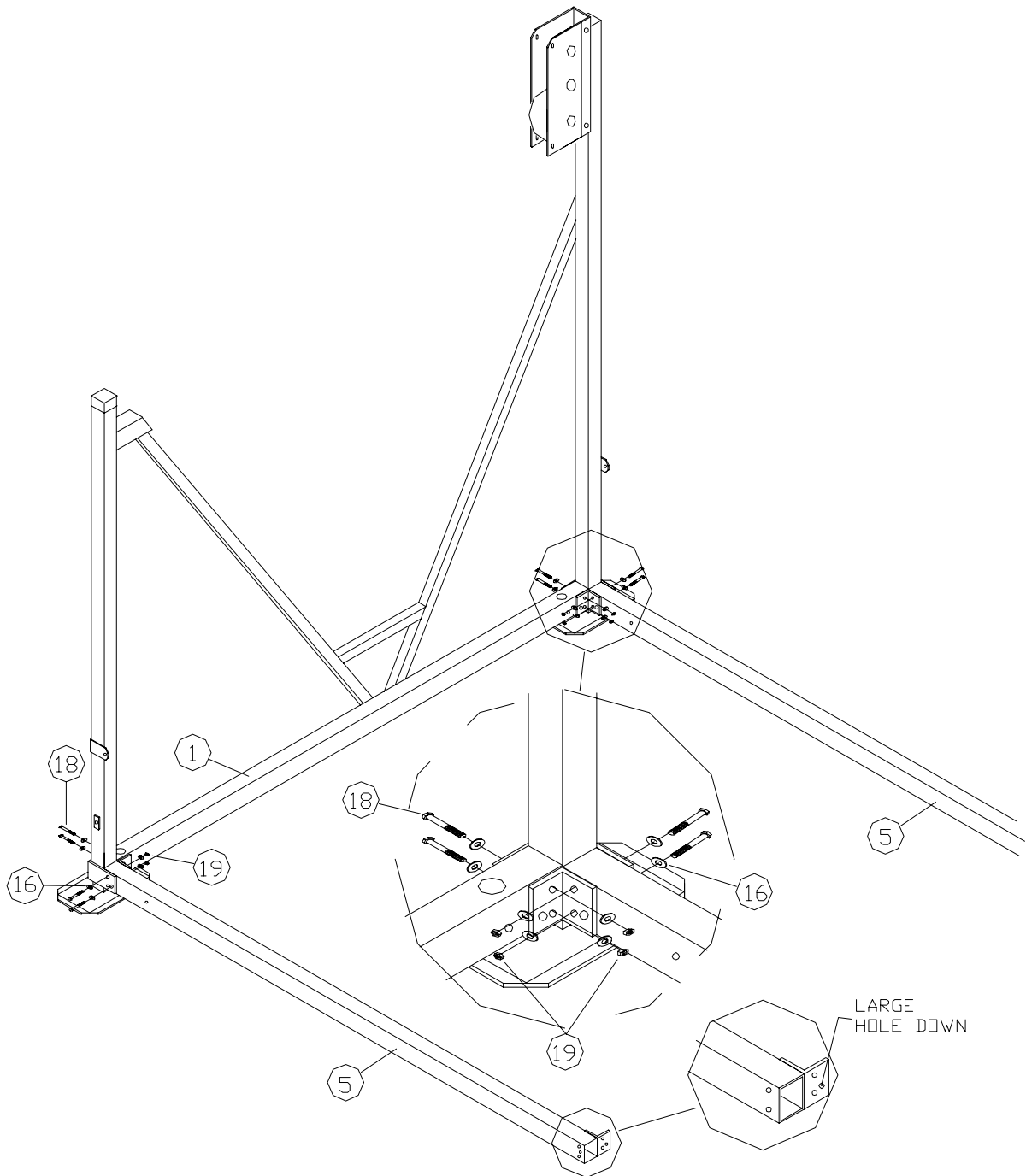

STEP 4. Locate the two 2" x 4 3/4" x 117 1/2" top bed cross tubes. The tube with a single cable protruding from each end is the winch bed cross tube. (**Ref. # 6**). The other one with the two cables on each end is the anchor cross tube (**Ref. # 7**). From the inside of the lift frame, on the winch end, place the winch bed cross tube across the end of the lift, so that the nylon slide angles are up against the inside corners of the side member upright tubes. Take the anchor cross bed tube and place across the other end of the lift frame so that the bottom loops of the cable are in the cutout holes of the bottom side tube of the side members and the nylon slide angles are against the uprights as on the other bed cross tube.

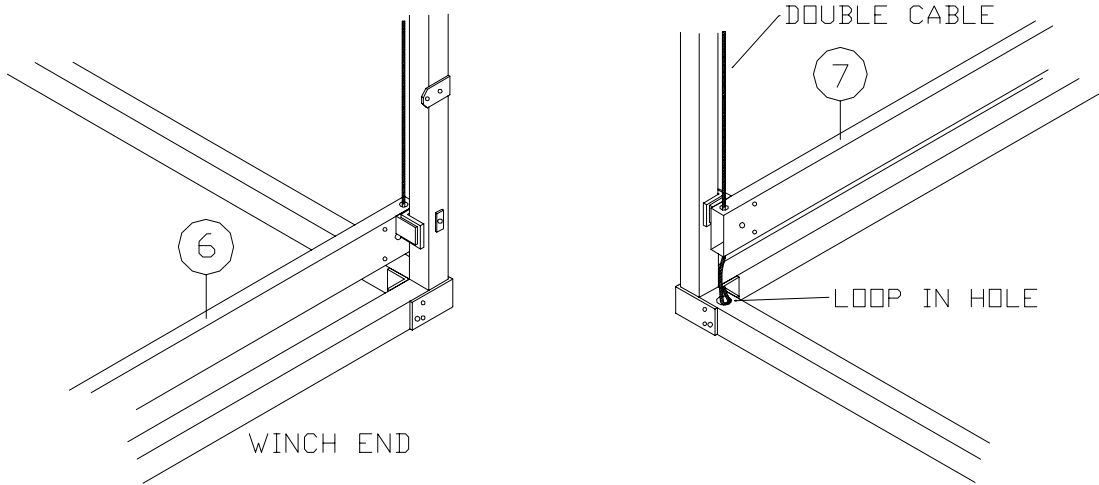

STEP 5. Assembly may be easier if 2" x 4" 's are laid diagonally on end, across the bottom four corners of the lift and the bed is assembled on top of the 2" x 4"s. Take the two 2" x 4 1/2" x 104" side bed tube cable assembly tubes (**Ref. # 8 & 9**). With the cable loop end down and toward the winch end of the lift, fasten the end of the side rail tube to the two holes in the bed cross tubes with 3/8" x 3" bolts, washers & nuts (**Ref. # 20, 16 & 19**). Place cable loops into the cutout holes of the bottom tube of the side members. Secure in place with 7/16" x 3 1/2" stainless bolts, washers & nuts. (**Ref. # 38, 41 & 39**) Secure the cable loops of the anchor bed cross tubes, on the other end of the lift with a 7/16" x 4 1/2" bolts, washers & nuts (**Ref. # 40, 41 & 39**). Using a tape measure square the corners of the lift to within a 1/4" or less. Tighten all bolts at this time.

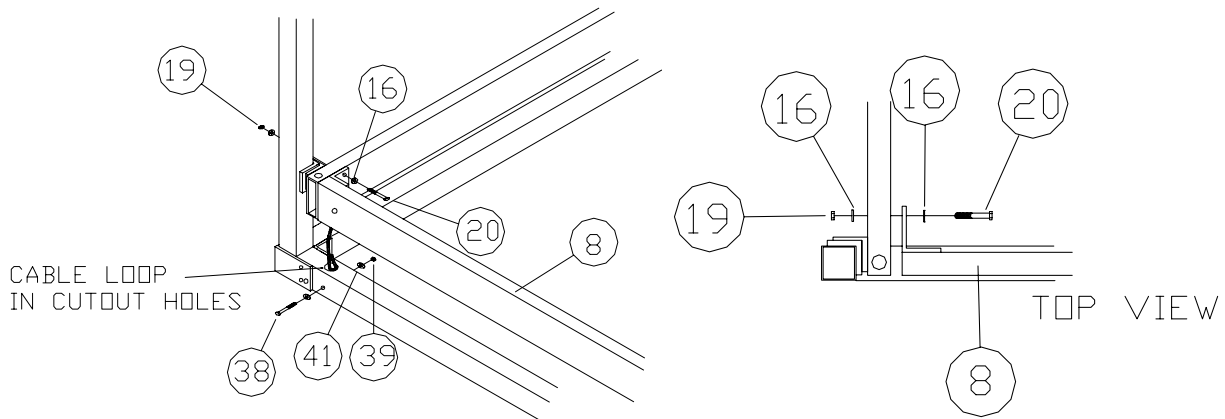

STEP 6. Take the winch nut, washer (**Ref. # 25 & 27**) and plastic shipping collar off the winch shaft, if possible lubricate the winch shaft with a light lubricant. Thread on the winch wheel (**Ref. # 10**) and replace washer and nut. Tighten the winch acorn nut onto the winch shaft. There will be roughly 1/8" clearance between the winch washer and the winch wheel Turn the wheel clockwise until the pocket that is welded to the inside of the left side of the winch drum is toward the front edge of the winch. Take the plain end of the winch cable and bring it up through the backside of the winch drum, down and through the pocket on the inside of the drum. Take the cable wedge (taped to the side of the winch) and from the end pound the wedge into the pocket, until tight.

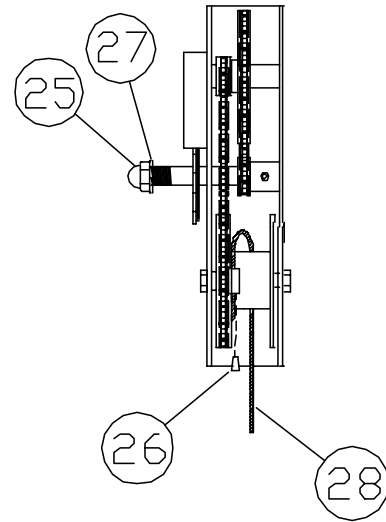

STEP 7. As a reference, the corners are marked below on the assembly drawing.

At corner B, slide a rubber stop tube (**Ref. # 11**) onto the cable. Fasten the cable stud to the top cross tube of the anchor side member, using the 1/4" x 2.5" x 2.5" winch cable support plate, 1/2" washer, and nut. (**Ref. # 21, 22 & 31**)

At corner C slides a rubber stop tube onto the cable that is closest to the upright tube. Fasten both cable studs to the top cross tube of the anchor side member using the 1/4" x 2.5" x 6" cable support plate (**Ref.# 23**) and 3/8" washers, fender washers, and nuts. (**Ref. # 16, 15, & 19**).

At corner D slides a rubber stop tube onto the cable that is closest to the upright tube. Fasten both cable studs to the winch side member at the horizontal stub with 3/8 washers, fender washers, and nuts. (**Ref. # 16, 15, & 19**) While standing on the double cable corner of the lift bed, Adjust the nuts on the cable studs until the cables have the same amount of tension and the bed is just off the 2" x 4"'s.

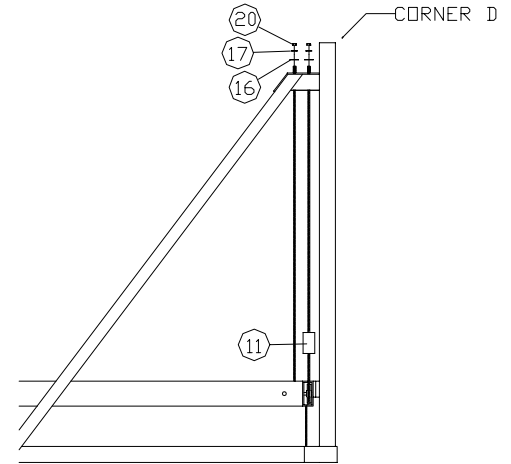

Repeat procedure on the other double cable corner.

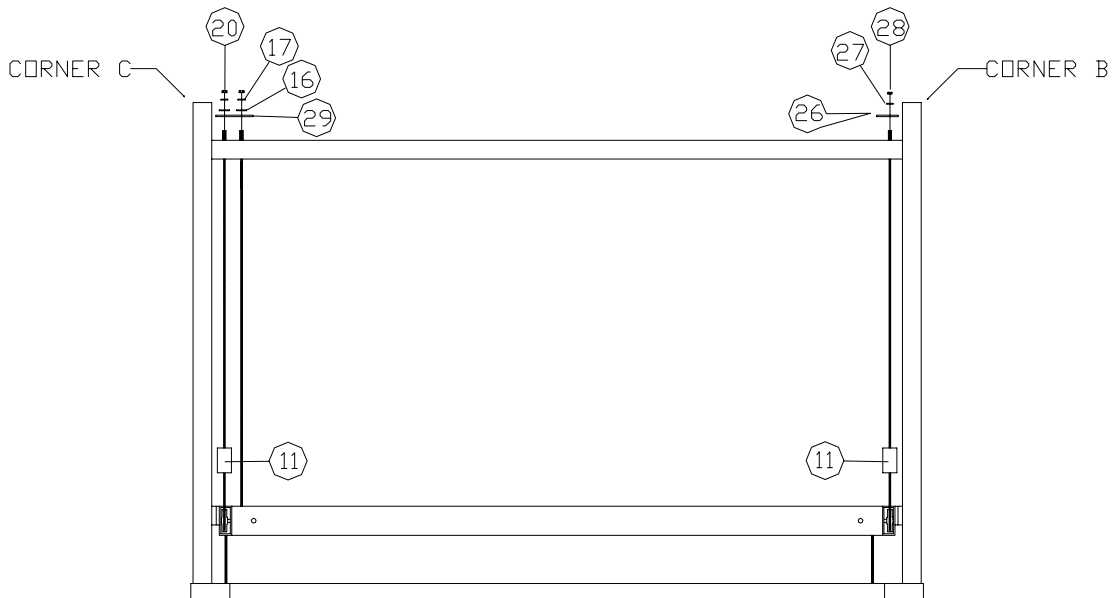

STEP 8. Bolt the four diagonal braces (**Ref. # 29**) into the four bottom corners of the lift by placing a 3/8" x 4" bolt and washer (**Ref. # 37 & 16**) through the round hole of the brace and into the hole of the bottom cross tube and finger tighten with washer and nut (**Ref. # 16 & 19**). Place a 3/8" x 1 1/4" bolt and washer (**Ref. # 30 & 16**) through the slotted hole of the brace into the tab of the upright tube. Tighten bottom bolts at this time. Check to see if the side upright tubes are parallel with each other. Adjust if necessary by pushing in or pulling out on the tube. When adjusted correctly, tighten the top bolts on the braces.

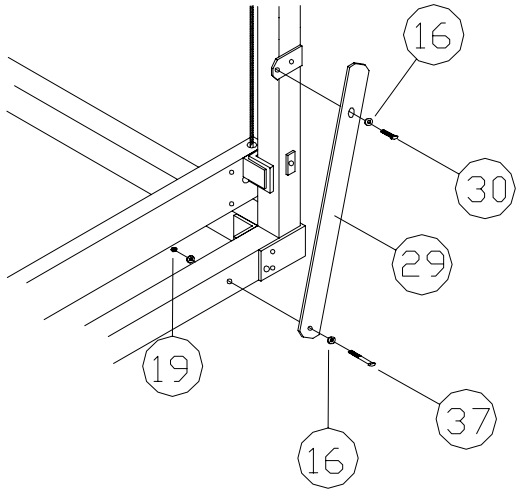

STEP 9. APL

Raise bed of lift to working height. Place the four bed members (**Ref. # 12**) over the bed cross tubes so that the holes that are in the farthest from the end of the bed member are toward the outside of the lift and most of the bed member is offset toward the center of the lift. Fasten in place by placing a backer plate (**Ref. # 13**) Under the bed cross tube and by placing a 3/8" x 7 1/2" carriage bolt (**Ref. # 14**) through the bed member and backer plate. Secure with 3/8" washer and nut.

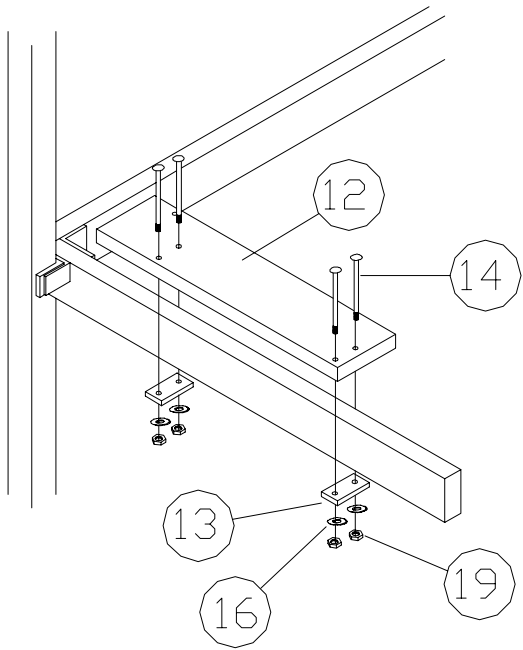

STEP 10. DPL

Find the four bottom mounting brackets (large channel with a upright tube in the center (**Ref. # 32**), set the bottom brackets over the top cross tubes of the lift. Place 3/8" x 3" bolts, washers and nuts (**Ref. # 20, 16 & 19**) into the bottom holes. Set according to inside width of pontoon floats and tighten nuts.

Locate the top rail bracket (angle with a tube in the center) (**Ref. # 33**) with the tube of the top bracket to the inside of the lift and flat part of the angle to the outside, place the rail bracket into the tubes of the bottom mounting bracket.

Bolt the long 2" x 8" x 14' rail boards (**Ref. # 34**) to the side of the top rail bracket with 3/8" x 2 1/2" carriage bolts, washer and nut (**Ref. # 36, 22 & 19**). Have the 45 degree cut end of the rail board to the back of the lift. Bolt the four 2" x 4" skid boards (**Ref. # 35**) to the top of the top rail bracket using 3/8" x 2 1/2" carriage bolts.

Place the 1/2" x 1" set screws (**Ref. # 17**) into the bottom mounting brackets. Set to height (usually 1" to 2" higher than the pontoon floats) and tighten set screws.

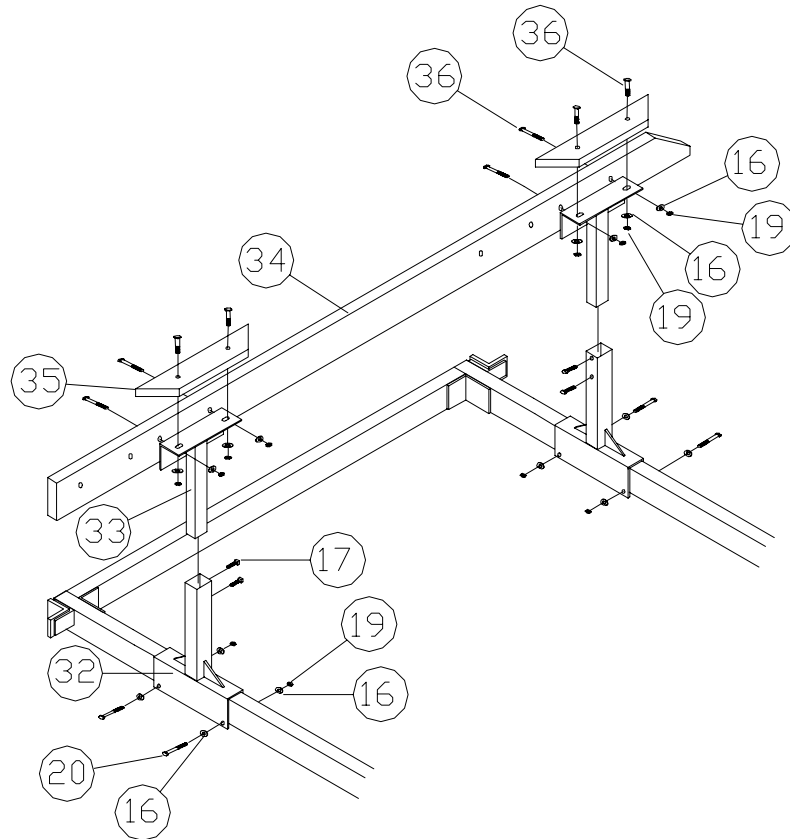

STEP 11. FPB

Raise the bed of the lift to working height. Set the bunk brackets (**REF. # 43**) over the front and rear

cross bars of the lifts bed with the pockets toward the center of the lift. Set to desired width and secure with 3/8" X 3" bolts, washers, and nuts (REF. # 20, 16, & 19).

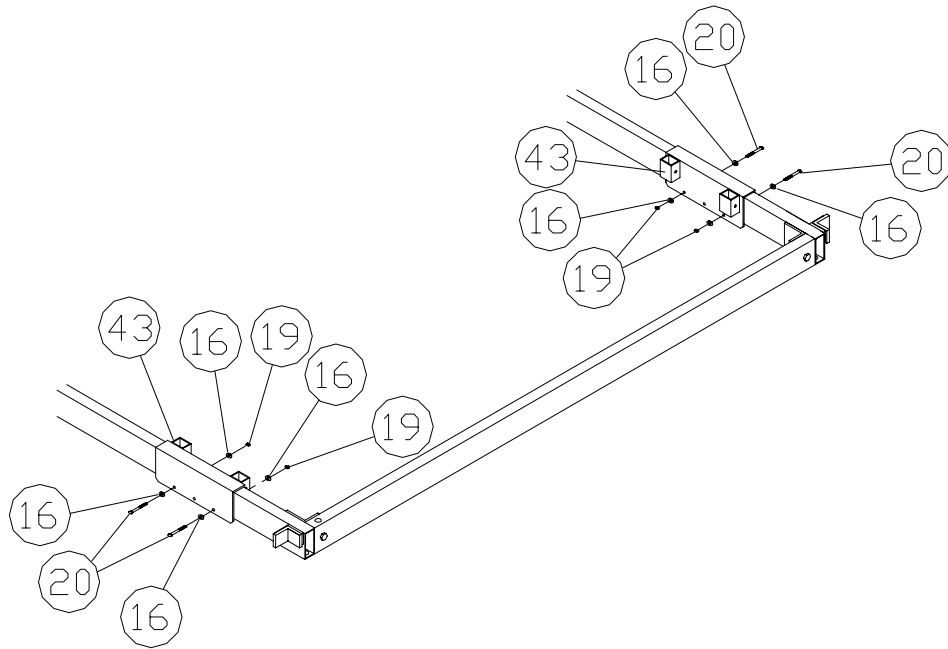

Step 12. Place the bunk uprights (REF. # 46) into the pockets and secure with 3/8" X 3" bolts and nuts (REF. # 20 & 19) Place the bunk (REF. # 44) on the uprights with the tapered end toward the back of the lift. Secure with 3/8" X 2 1/2" bolts and lock nuts (REF. # 45 & 24). Tip bunks inward slightly and tighten bolts so that the bunks will not turn freely but can pivot when weight is applied.

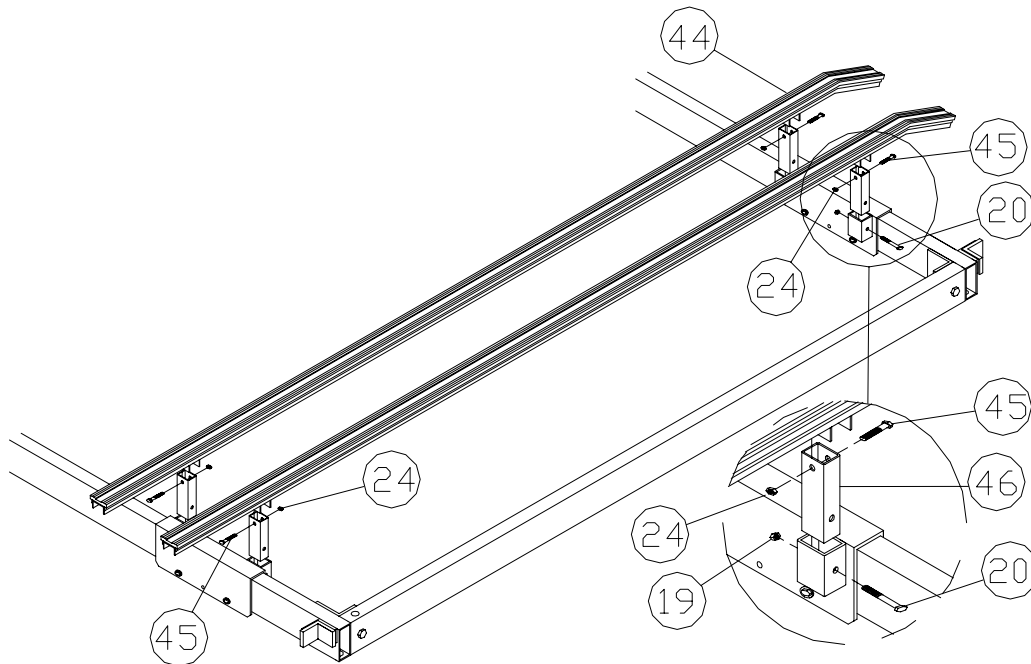

STEP 13. When placing lift in the lake, you must level the lift as close as possible for the lift to operate correctly. When tightening your set screws, finger tighten until tight and then tighten 2 1/2" to 3 1/2" turns after you start feeling resistance with a wrench. When raising your boat, check and see if the bed is rising evenly and that all cables have about the same tension. If bed is coming up crooked, check lift for levelness, if lift is level, remove boat and adjust cable nuts to level bed.

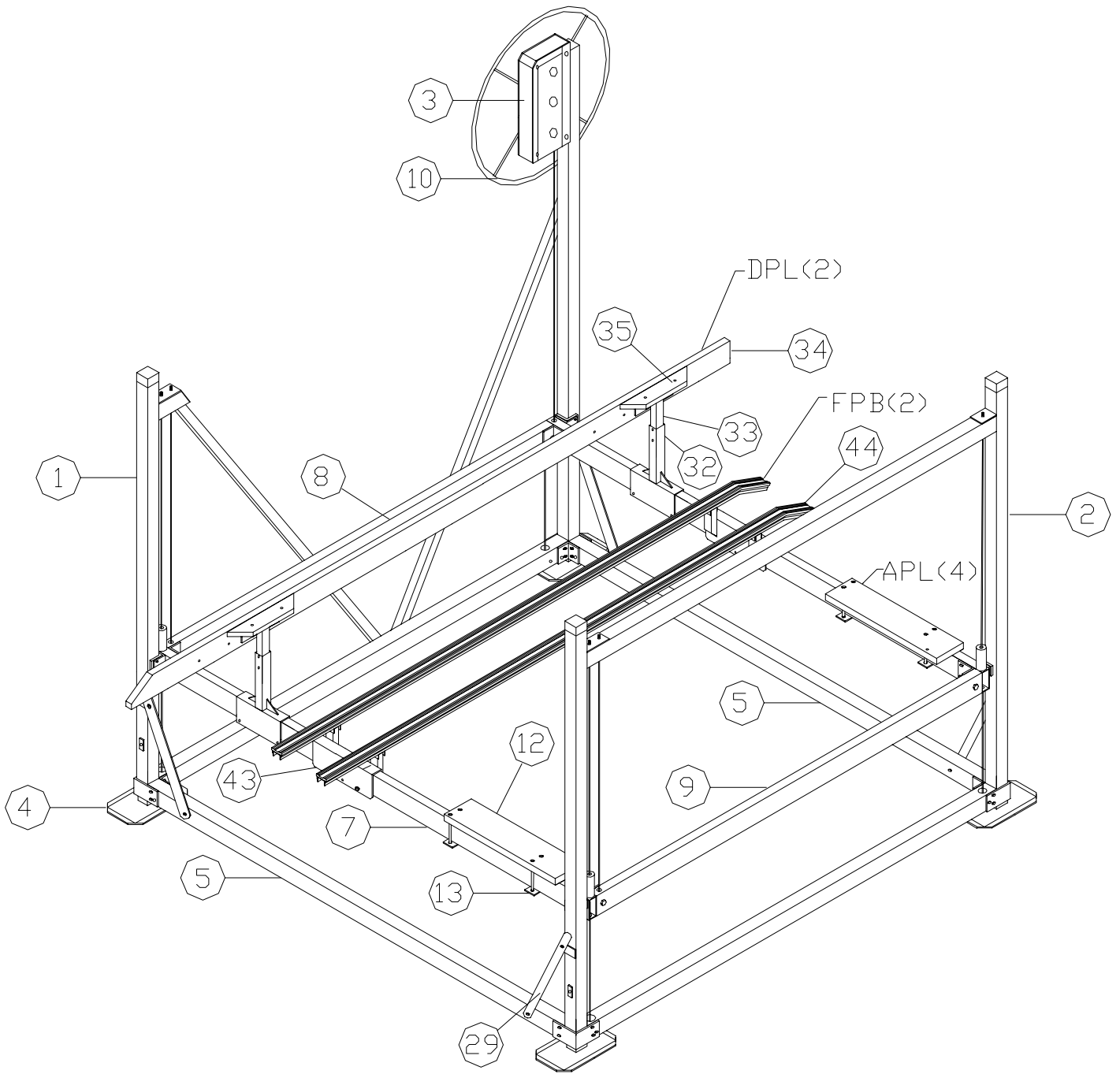

PARTS LIST

37A/38A/271A 30113V & 232A/233A/276A 30120V

APL/DPL/FPB
ALUMINUM VERTICAL PONTOON LIFT CHAIN DRIVE

REF. #	PART NO.	DESCRIPTION	37A	38A	232A	233A	271A	276A
			APL	DPL	APL	DPL	FPB	FPB
1	30H	SIDE MEMBER WINCH 30113V	1	1	-	-	1	-
	33H	SIDE MEMBER WINCH 30120V	-	-	1	1	-	1
2	31H	SIDE MEMBER ANCHOR 30113V	1	1	-	-	1	-
	34H	SIDE MEMBER ANCHOR 30120V	-	-	1	1	-	1
3	3H	WINCH 3026 W/PLATE	1	1	1	1	1	1
4	60H	LEVELING LEG	4	4	4	4	4	4
5	50H	BOTTOM CROSS TUBE 30113V	2	2	-	-	2	-
	39H	BOTTOM CROSS TUBE 30120V	-	-	2	2	-	2
6	42H	WINCH END BED CROSS TB 30113V	1	1	-	-	1	-
	35H	WINCH END BED CROSS TB 30120V	-	-	1	1	-	1
7	43H	ANCHOR CROSS TUBE 30113V	1	1	-	-	1	-
	36H	ANCHOR CROSS TUBE 30120V	-	-	1	1	-	1
8	45H	SIDE BED CROSS TUBE RIGHT 30113V	1	1	-	-	1	-
	37H	SIDE BED CROSS TUBE RIGHT 30120V	-	-	1	1	-	1
9	44H	SIDE BED TUBE LEFT 30113V	1	1	-	-	1	-
	38H	SIDE BED TUBE LEFT 30120V	-	-	1	1	-	1
10	45F	LIFT WHEEL	1	1	1	1	1	1
11	4513	RUBBER STOP 4"	3	3	3	3	3	3
12	50059	BED MEMBER	4	-	4	-	-	-
13	50144	BED MEMBER BACKER PLATE	8	-	8	-	-	-
14	5186	CARRIAGE BOLT 3/8" X 2 1/2"	16	-	16	-	-	-
15	5067	FENDER WASHER 3/8"	6	6	6	6	6	6
16	5070	WASHER 3/8"	92	108	92	108	92	108
17	5174	SET SCREW 1/2"	4	12	4	12	4	4
18	5087	BOLT 3/8" X 4 1/2"	16	16	16	16	16	16
19	5056	NUT 3/8"	58	74	58	74	65	65
20	5084	BOLT 3/8" X 3"	8	16	8	16	32	32
21	30025	WINCH CABLE SUP PLATE 2.5"X2.5"	1	1	1	1	1	1
22	5071	WASHER 1/2"	1	1	1	1	1	1
23	30026	CABLE SUPPOR PLATE 2.5" X 6"	1	1	1	1	1	1
24	5038	LOCKNUT 3/8"	-	-	-	-	8	8
25	3027	WINCH NUT	1	1	1	1	1	1
26	3007	CABLE WEDGE	1	1	1	1	1	1
27	5072	WINCH NUT WASHER 5/8"	1	1	1	1	1	1
29	30009	DIAGONAL BRACE	4	4	4	4	4	4
30	5091	BOLT 3/8" X 1 1/4"	4	4	4	4	4	4
31	5058	NUT 1/2"	1	1	1	1	1	1
32	11C	BOTTOM BRACKET	-	4	-	4	-	-
33	12C	TOP RAIL BRACKET	-	4	-	4	-	-
34	50200	RAIL	-	2	-	2	-	-
35	50201	SKID BOARD	-	4	-	4	-	-
36	5195	CARRIAGE BOLT 3/8" X 2 1/2"	-	16	-	16	-	-
37	5089	BOLT 3/8" X 4" GR2	7	7	7	7	7	7
38	5148	BOLT SS 7/16" X 3 1/2"	2	2	2	2	2	2
39	5057	NUT 7/16"	4	4	4	4	4	4
40	5149	BOLT SS 7/16" X 4 1/2"	2	2	2	2	2	2
41	5069	WASHER 7/16"	8	8	8	8	8	8
42	3823	CAP 3" SQUARE GRAY	3	3	3	3	3	3
43	48F	BUNK BRACKET DOUBLE FPB	-	-	-	-	4	4
44	65C	BUNK AND PAD 136.5"	-	-	-	-	4	-
44	87C	BUNK AND PAD 156"	-	-	-	-	-	4
45	5083	BOLT 3/8" X 2 1/2"	-	-	-	-	8	8
46	50335	BUNK UPRIGHT	-	-	-	-	8	8

08/16/04

U:\JUDY\INSTR 2002 LIFTS\LIFT INST 30113V/30120V APL/DPL/FPB

PAGE 10 OF 12

CHAIN WINCH MOUNTING INSTRUCTIONS

STEP 1. Because of the hole placement on the winch, it maybe easier to remove the back mounting channel (**Ref. No. 2**) and bolt it to the inside of the lifts upright first and then re-bolt the winch assembly (**Ref. No. 4**) to the back mounting channel.

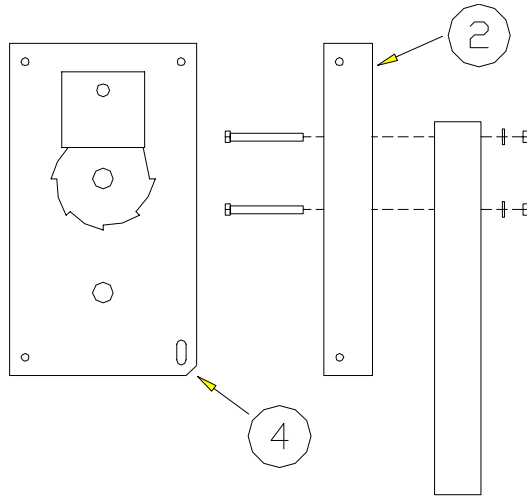

30113V/ 30120V & 40113V/40120V TOP BED ASSEMBLY PARTS LISTS

Ref.no.	Part no.	Description	301130V		40113V		
			30120V	40120V	30120V	40120V	
1.	20H	Side Bed Tube Left	30113V/40113V	1	-	1	-
	19H		30120V/40120V	-	1	-	1
2.	21H	Side Bed Tube Right	30113V/40113V	1	-	1	-
	18H		30120V/40120V	-	1	-	1
3.	40H	Winch End Bed Cross Tube Sgl Cable	30113V	1	-	-	-
	15H		30120V	-	1	-	-
	54H	Winch End Bed Cross Tube Sgl Cable	40113V	-	-	1	-
	10H		40120V	-	-	-	1
4.	41H	Anchor End Bed Cross Tube Dbl Cable	30113V	1	-	-	-
	16H		30120V	-	1	-	-
	56H	Anchor End Bed Cross Tube Dbl Cable	40113V	-	-	1	-
	11H		40120V	-	-	-	1
5.	3316	4" Nylon Single Pulley		2	2	2	2
6.	3317	4" Nylon Double Pulley		2	2	2	2
7.	5092	Hitch Pin 1/8"		2	2	2	2
8.	3042	Cable SS 1/4" x 177"		2	-	2	-
	3115	Cable SS 1/4" x 196 1/4"		-	2	-	2
9.	3041	Cable SS 1/4" x 191.5"		2	-	2	-
	3116	Cable SS 1/4" x 198 3/4"		-	2	-	2
10.	3114	Cable Galv. 5/16" x 290"		1	1	1	1
11.	5045	Clevis Pin SS .625" x 2.5"		2	2	2	2
12.	3827	Cap 2" x 4.7" End Cap Vertical Upright		2	2	2	2
13.	4994	Machine Flat Head 1/4" x 7/8" Screw		2	2	2	2
14.	5053	Locknut 1/4" Keys		2	2	2	2
15.	30016	Plastic Slide Angle .50" x 3" x 3" x 2.5" UHMW		2	2	2	2

3000V/4000V SIDE BED TUBE LEFT AND RIGHT

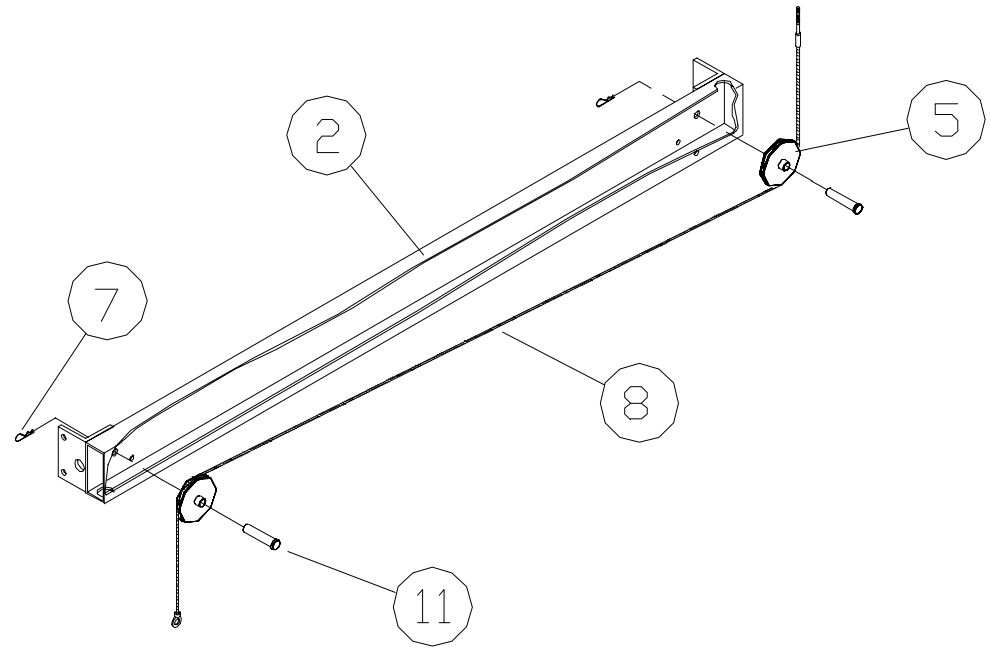
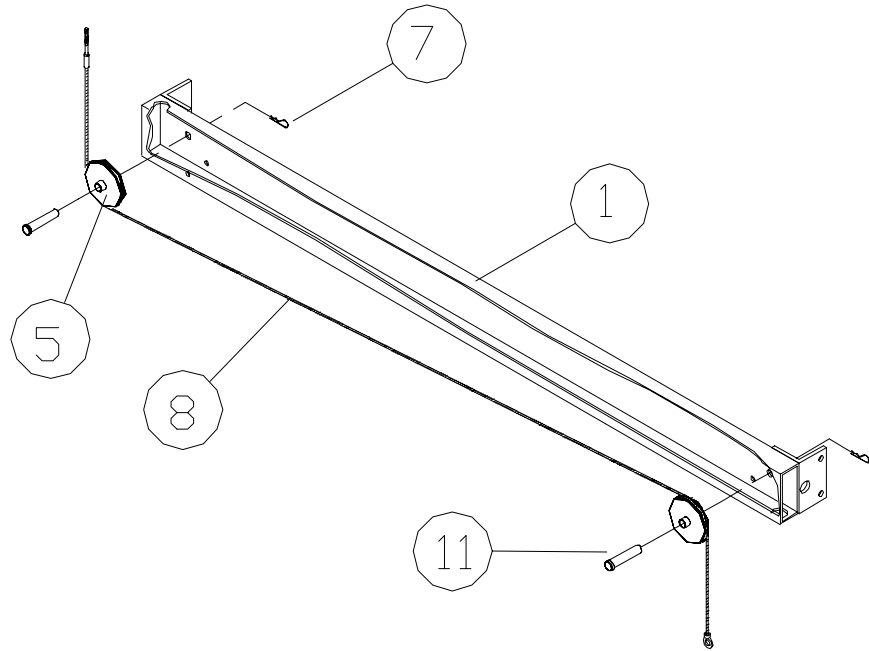

3000V WINCH & ANCHOR CROSS TUBE

