

## 153A 2000 LB Gear Drive Winch Aluminum Narrow Pontoon Lift

**Thank you for purchasing a PORTA-DOCK product.**  
**\*Please read these instructions and follow them step by step.\***

**STEP 1.** Locate the four adjustable legs (**REF. # 1**). Slide them into the ends of the side members (**REF.# 3 & 4**). Fasten with  $\frac{1}{2}$ " x 1" set screws (**REF.#13**). Now set the side member about 4' apart making sure the two flat tabs on the bottom rail of the side members are facing inward.

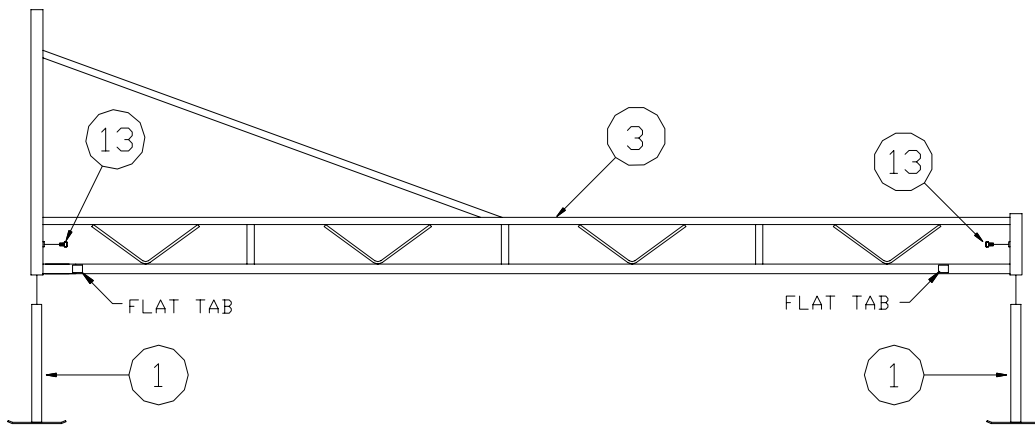

**STEP 2.** Find the two bottom cross bars (**REF. # 5**). With the channels facing to the rear of the lift, set them between the side members so that the end plate is up against the end of the tabs that are welded on the bottom side tube. Fasten to the bottom tube of the side member with  $\frac{3}{8}$ " x  $2 \frac{1}{16}$ " x  $2 \frac{3}{4}$ " u-bolts and  $\frac{3}{8}$ " flange nuts (**REF.# 14 & 18**).

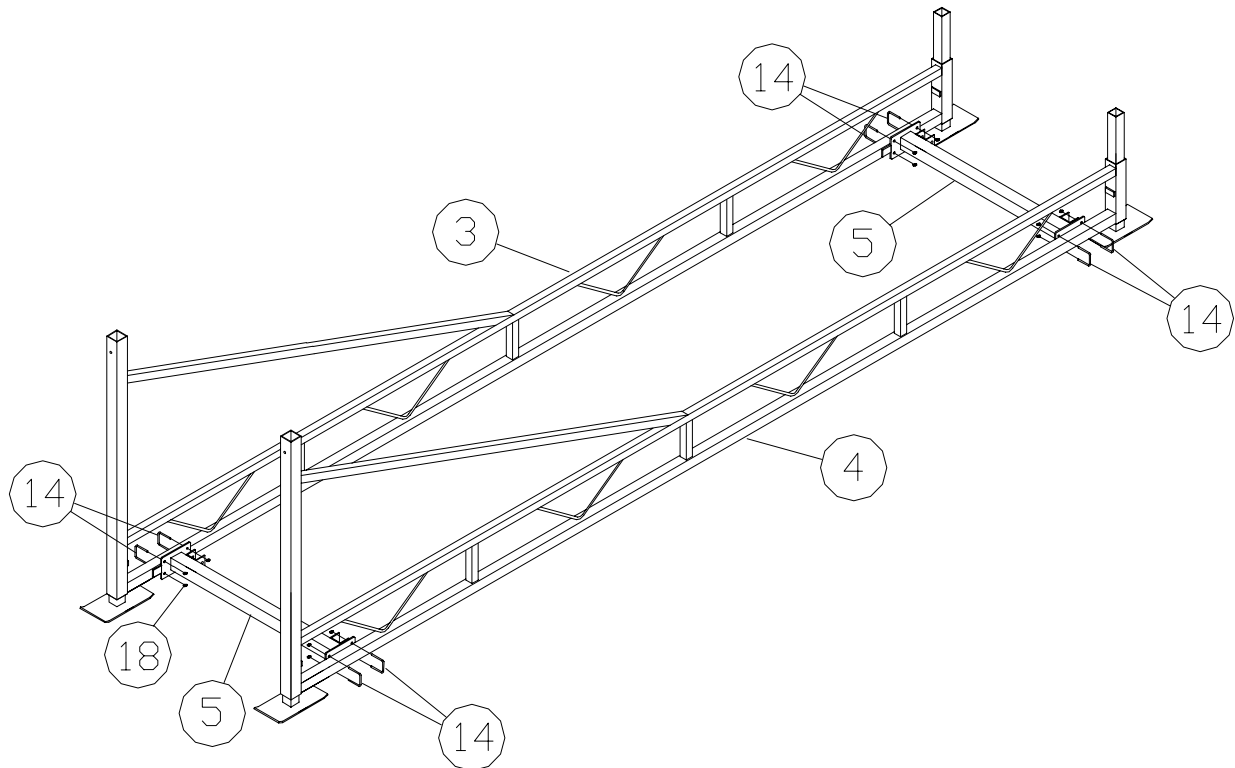

**STEP 3.** Locate the lifting arms (REF. # 2).

**NOTE: THE CROSS BARS ON THE LIFTING ARMS HAVE TO BE TO THE TOP.**

Slide a brass pivot bushing (REF. # 24) into each pivot cap on the bottom ends of the lifting arms. Mount the lifting arms to the bottom cross bar pivot channel using  $\frac{1}{2}$ " x 3" clevis pins,  $\frac{1}{2}$ " washers and  $\frac{1}{8}$ " x 1" cotter pin (REF.#22, 25 & 23). Make sure both legs of the cotter pin are bent in opposite directions.

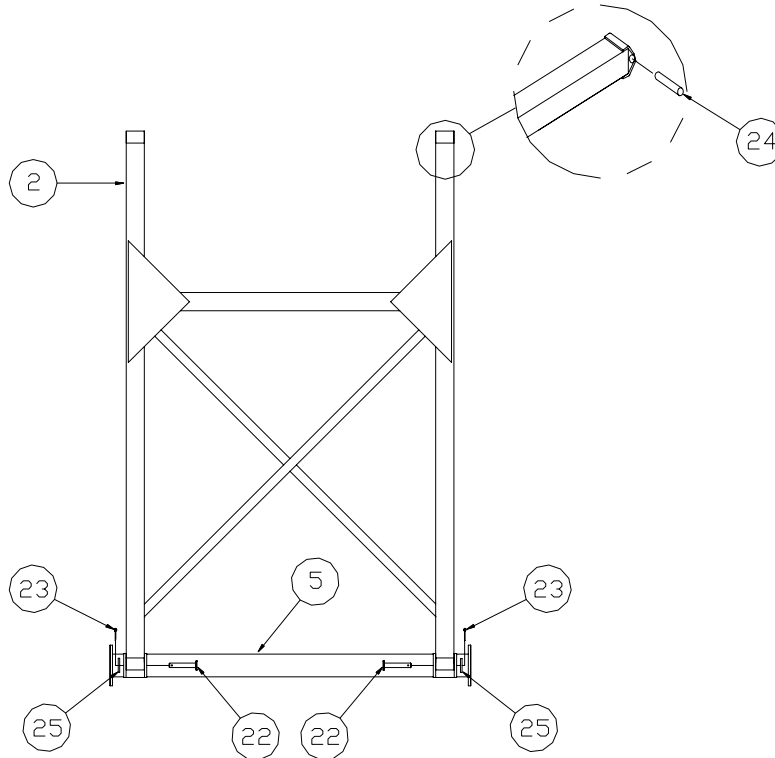

**STEP 4.** Slide a brass pivot bushing (REF.# 24) into the top pivot caps in the lifting arms.

Mount the two rail tubes (REF.# 6 & 7) with the angles to the front and the face to the outside.

Fasten with a  $\frac{1}{2}$ " x 3" clevis pin,  $\frac{1}{2}$ " washer and  $\frac{1}{8}$ " x 1" cotter pin (REF.# 22, 25 & 23). Bolt the rail support tube (REF.# 9) between the angles on the bunk tubes with  $\frac{3}{8}$ " x  $\frac{2}{1/2}$ " bolts,  $\frac{3}{8}$ " washers and  $\frac{3}{8}$ " nut (REF.# 28, 15 & 16).

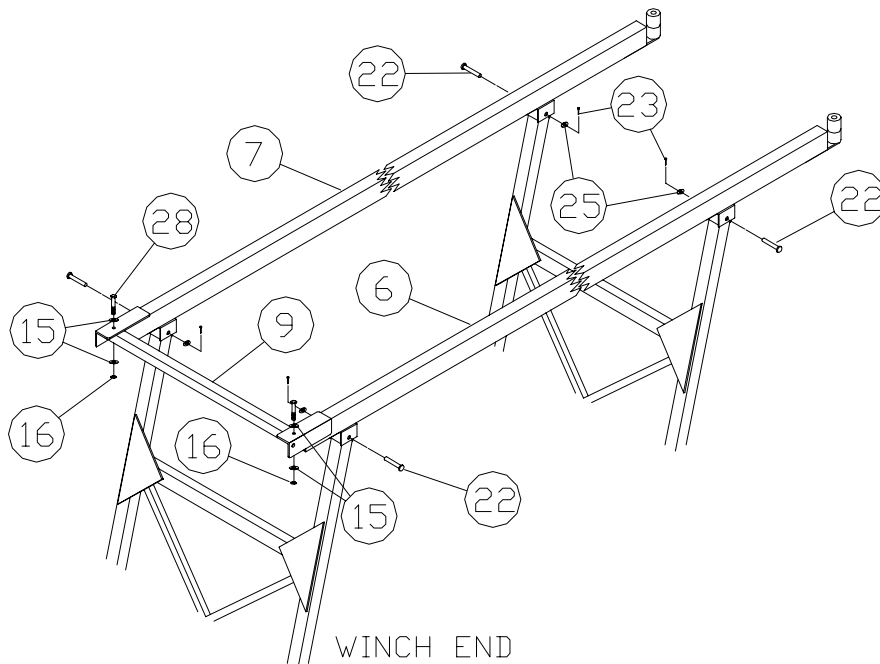

**STEP 5a** Find the winch stand bar (**REF.# 10**). Turn the winch stand bar so that the two short tubes are down and the longer winch upright tube is to the side where the winch will be installed. Mount the winch (**REF.# 11**) to the winch stand bar using 3/8" x 4" bolts, 3/8" washers, 3/8" fender washers and 3/8" nuts (**REF. # 26, 15, 17 & 16**). Locate the stop tube (**REF.#8**) and bolt it to the underside of the diagonal brace of the side member using 3/8" x 4" bolts, 3/8" washers and 3/8" nuts (**REF.# 26, 15 & 16**).

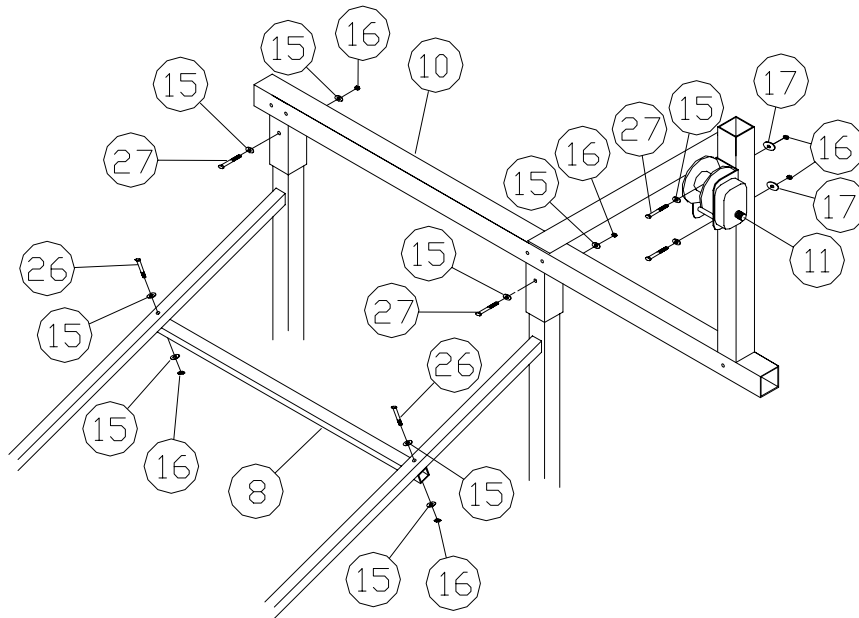

**STEP 5b** Find the 7/16" x 4" bolt. (**REF.# 37**). Slide on two 7/16" washers (**REF.# 38**), the 3 link pulley (**REF.# 19**) and five 7/16" washers (**REF.# 38**). Bolt this assembly to the winch stand bar below the winch. Secure with a 7/16" washer (**REF.# 38**) and 7/16" nut (**REF.# 39**). Locate the cable thimble (**REF.# 36**) and slide it onto a 3/8" x 4 5/8" round u-bolt (**REF.# 30**). Bolt the u-bolt to the winch stand bar below the diagonal brace as shown using a support plate, 3/8" washers and 3/8" locknuts (**REF.# 32, 15 & 21**).

Slide a two link pulley (**REF.# 20**) onto a 3/8" x 4 5/8" round u-bolt (**REF.# 30**). Bolt the u-bolt to the end of the winch stand bar using a support plate, 3/8" washers and 3/8" locknuts (**REF.# 32, 15 & 21**). Leaving nuts loose enough so the pulley and chain can still pivot.

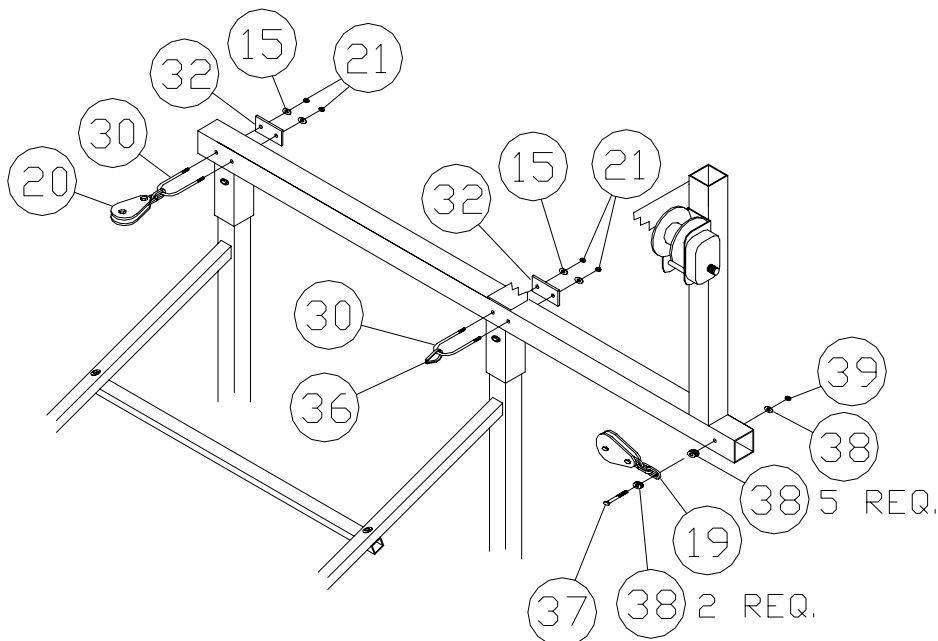



**PARTS LIST**  
**153A 2000 LB. Gear Drive Winch**  
**ALUMINUM NARROW PONTOON LIFT**

| <b>REF#</b> | <b>PART#</b> | <b>DESCRIPTION</b>                 | <b>QTY</b> |
|-------------|--------------|------------------------------------|------------|
| 1           | 61H          | Leveling Legs                      | 4          |
| 2           | 76Q          | Lifting Arm                        | 2          |
| 3           | 72Q          | Side Member Left                   | 1          |
| 4           | 73Q          | Side Member Right                  | 1          |
| 5           | 79Q          | Bottom Cross Bar                   | 2          |
| 6           | 81Q          | Rail Tube W/Rollers Right          | 1          |
| 7           | 82Q          | Rail Tube W/Rollers Left           | 1          |
| 8           | 50281        | Stop Tube                          | 1          |
| 9           | 50282        | Rail Support Tube                  | 1          |
| 10          | 80Q          | Winch Stand Bar                    | 1          |
| 11          |              | Winch                              |            |
| 12          | 51E          | Lift Wheel DL                      | 1          |
| 13          | 5174         | Set Screw 1/2" x 1"                | 4          |
| 14          | 5046         | U-Bolt Sq. 3/8" x 2 1/16" x 2 3/4" | 12         |
| 15          | 5070         | Washer 3/8"                        | 22         |
| 16          | 5056         | Nut 3/8"                           | 8          |
| 17          | 5067         | Fender Washer 3/8"                 | 2          |
| 18          | 5156         | Flange Nut 3/8"                    | 16         |
| 19          | E69          | 2 1/2" Pulley & 3 Link Chain       | 1          |
| 20          | E75          | 2 1/2" Pulley & 2 Link Chain       | 3          |
| 21          | 5038         | Locknut 3/8"                       | 6          |
| 22          | 5097         | Clevis Pin 1/2" x 3"               | 8          |
| 23          | 5025         | Cotter Pin 1/8" x 1"               | 8          |
| 24          | 3313         | Brass Pivot Bushing                | 8          |
| 25          | 5071         | Washer 1/2"                        | 8          |
| 26          | 5089         | Bolt 3/8" x 4"                     | 2          |
| 27          | 5085         | Bolt 3/8" x 3 1/2"                 | 4          |
| 28          | 5083         | Bolt 3/8" x 2 1/2"                 | 2          |
| 29          | 5088         | Bolt 3/8" x 1 1/2"                 | 2          |
| 30          | 5049         | U-Bolt Round 3/8" x 4 5/8"         | 2          |
| 31          | 3823         | Plastic Cap 3" x 3"                | 2          |
| 32          |              | Cable Support Plate                | 2          |
| 33          | 3054         | Cable 1/4" x 26'                   | 1          |
| 34          | 5004         | Cable Clamp 1/4"                   | 1          |
| 35          | 3821         | Plastic Cap 2" x 2"                | 2          |
| 36          | 5044         | Cable Thimble                      | 1          |
| 37          | 5227         | Bolt 7/16" x 4"                    | 1          |
| 38          | 5069         | Washer 7/16"                       | 8          |
| 39          | 5057         | Nut 7/16"                          | 1          |

