

PORTA-DOCK, INC.

Thank you for purchasing a Porta-Dock product!

WE01 ELECTRIC WINCH

STEP 1. Bolt the mounting channel to the winch by bolting through the counter sunk holes using 3/8" tapered machine bolts, fender washers, washers, and nuts (**Ref. no. 5, 7, 8, 9**) making sure that the top hole in the channel is lined up with the second hole down in the winch. **NOTE:** the winch must be mounted so that the motor enclosure is to the outside of the lift. This is done by mounting the channel on the opposite end of the winch.

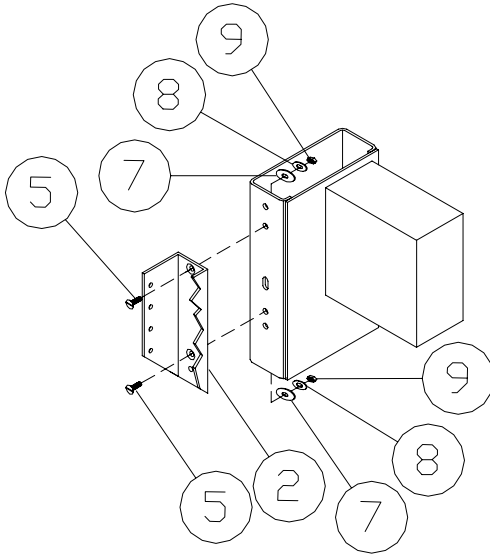

3000 lb. model

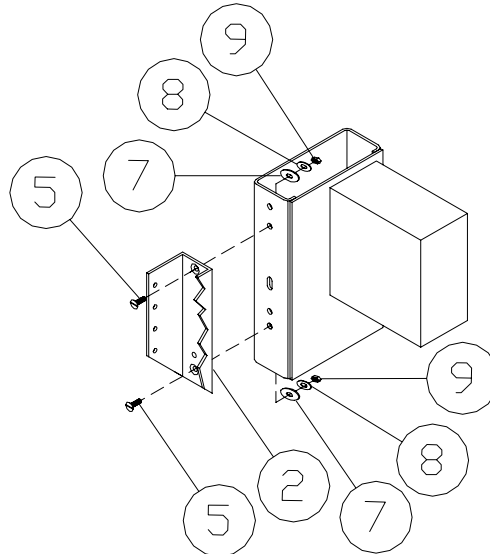

4000 lb. model

STEP 2. Slide the winch mounting channel onto the upright of the lift. Using the diagram below place two 3/8" bolts and washers (**Ref. no. 6 & 8**) (provided with the channel) through the side holes of the channel and install washers and nuts (**Ref. no. 8 & 9**) Take the remaining bolt and fender washer (**Ref. no. 6 & 7**) and slide it through the bottom hole of the lift's upright tube and into the hole in the winch. Making sure that the bolt can slide freely tighten the bolts through the side holes at this time. If not installing a canopy place washer and nut (**Ref. no. 8 & 9**) onto bolt and tighten. If installing a canopy remove bolt and slide a canopy mounting bracket into the upright tube, replace bolt and fender washer and secure with washer and nut.

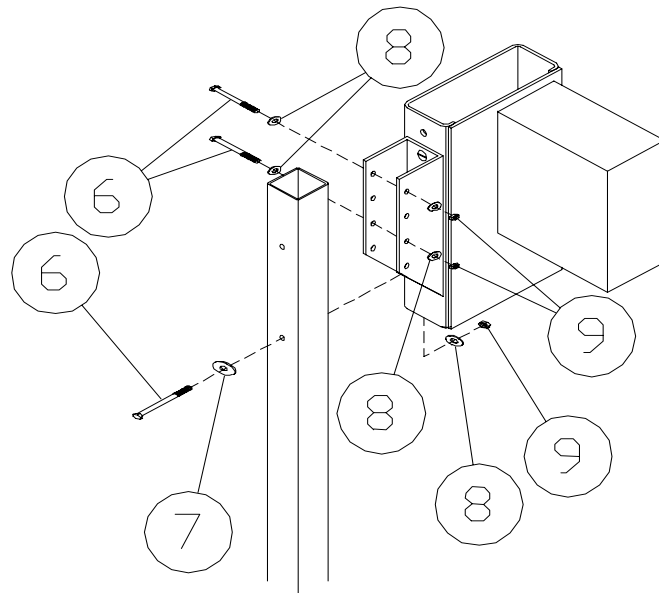
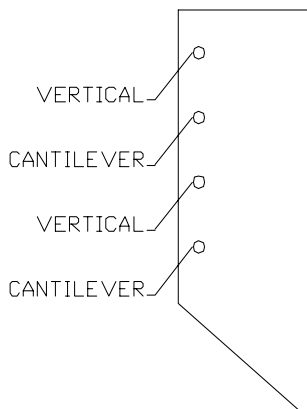

STEP 3. Bolt the solid top cover plate (**Ref. no. 3**) and the bottom slotted cover plate (**Ref. no. 4**) onto the winch with screws (**Ref. no. 10**).

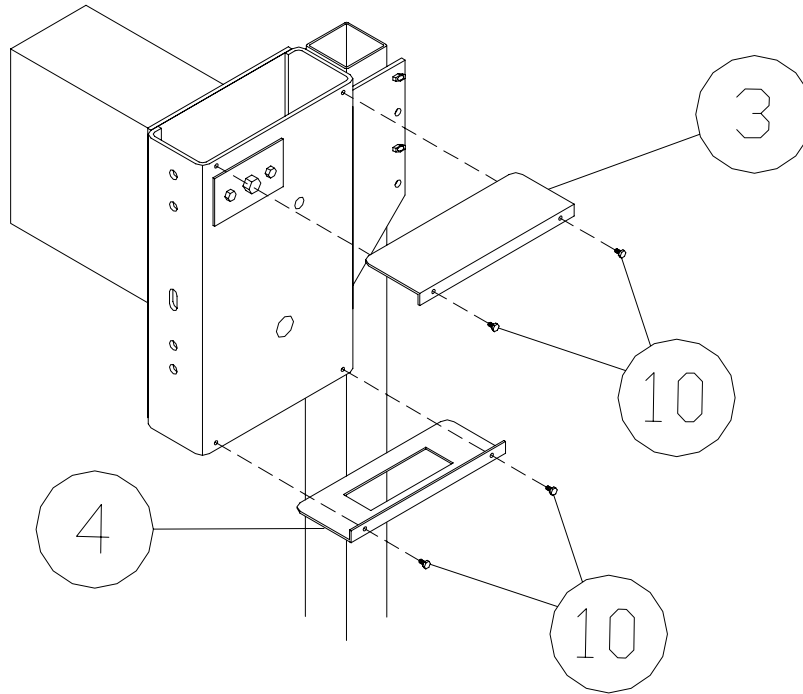

STEP 4. The cable is fastened to the drum of the winch by sliding the cable through the hole in the drum so it is flush with hole in the other side and tightening the allen head screw. To complete this step you will need to turn the drum. This can be done by powering the winch and using the switch, make sure the power is off before reaching into the winch. You can also use a 3/4" wrench to turn the bolt that is opposite of the motor cover box. When winding up the slack in the cable you may need to hand guide the cable onto the drum so it will wrap up evenly. **NOTE:** When wrapping the cable on the drum the cable must run between the lift side of the winch and the drum.

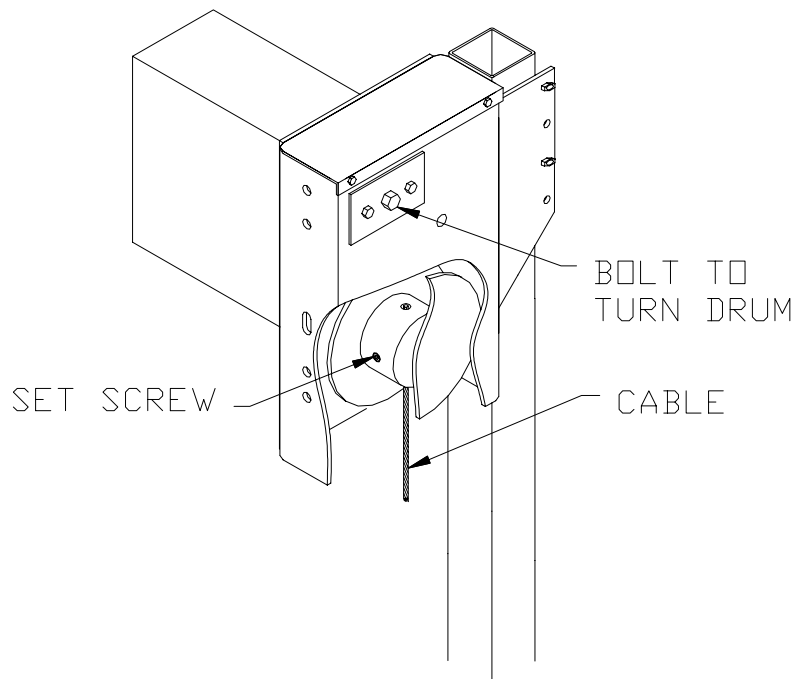

WE01 ELECTRIC WINCH PARTS LIST

REF #	PART #	DESCRIPTION	3000 QTY	4000 QTY
1		Winch	1	1
2		Winch mounting channel 3000	1	-
		Winch mounting channel 4000	-	1
3		Top cover plate	1	1
4		Bottom cover plate	1	1
5		Tapered machine bolt	2	2
6	5087	Bolt 3/8" X 4 1/2"	3	-
	5090	Bolt 3/8" X 5"	-	3
7	5067	3/8" Fender washer	3	3
8	5070	3/8" Washer	7	7
9	5056	3/8" nut	5	5
10		Cover screw	4	4