

F53 - APD, CPD L12 TRUSS BAR
F54 - AA L12 TRUSS BAR

Thank you for purchasing our product!

Please read these instructions and follow them step by step.

Step 1. Turn the truss bar (**REF. # 1**) so that the end with the two holes is toward the sixteen foot section. Place the truss bar underneath the docks frame so that it is about 16'' in front of the vertical lift member.

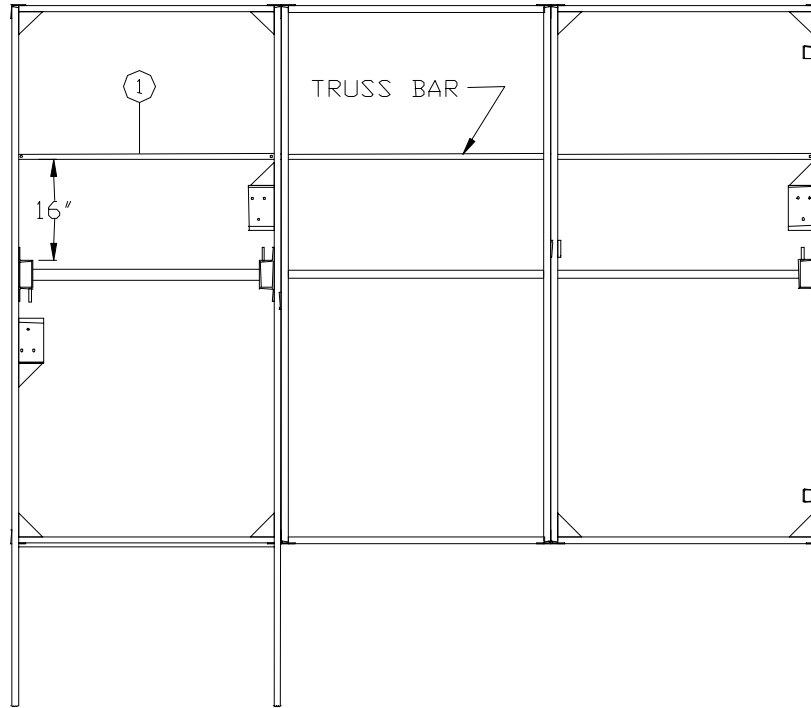

Step 2. Fasten truss bar to the bottom one-inch square tube of the docks frame with the three J-bolts, 5/16'' washers, and 5/16'' locknuts (**REF. # 2, 3, & 4**) as shown.

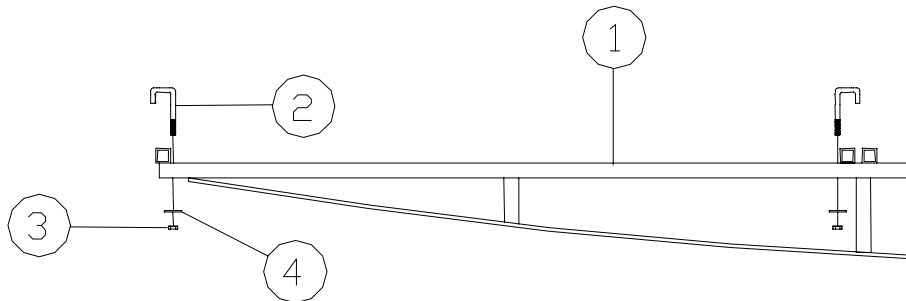

REF. #	PART #	DESCRIPTION	QTY
1	F63	APD, CPD Truss bar	1
	F64	AA Truss bar	1
2	5031	5/16'' J-bolt	3
3	5068	5/16'' washer	3
4	5040	5/16'' lock nut	3