

C25 2' VERTICAL POST DOCK BUMPER WITH BRACKET

Thank you for purchasing our product!
Please read these instructions and follow them step by step.

STEP 1. Bolt the vertical post dock bumper bracket (REF. # 1) to the back of the two foot vertical bumper (REF. # 2) using 3/8" X 2" bolts and washers (REF. # 3 & 4).

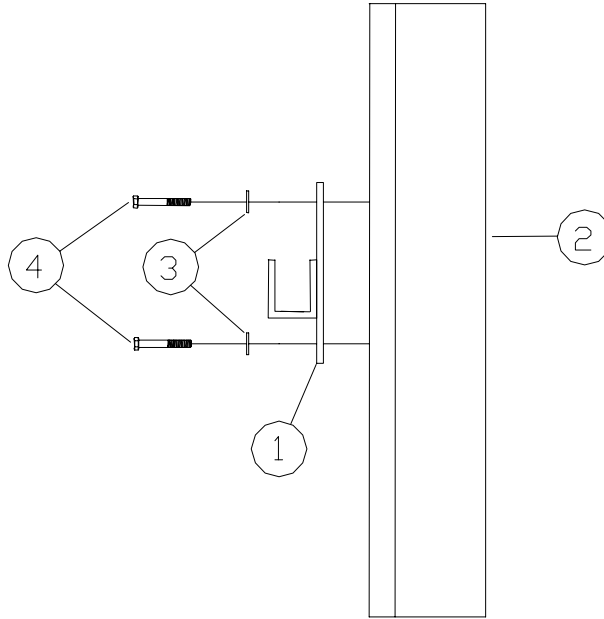

STEP 2. Slip the channel part of the bumper bracket into the frame work of the post dock section and secure in place with 1/2" X 2" set screw (REF. # 5).

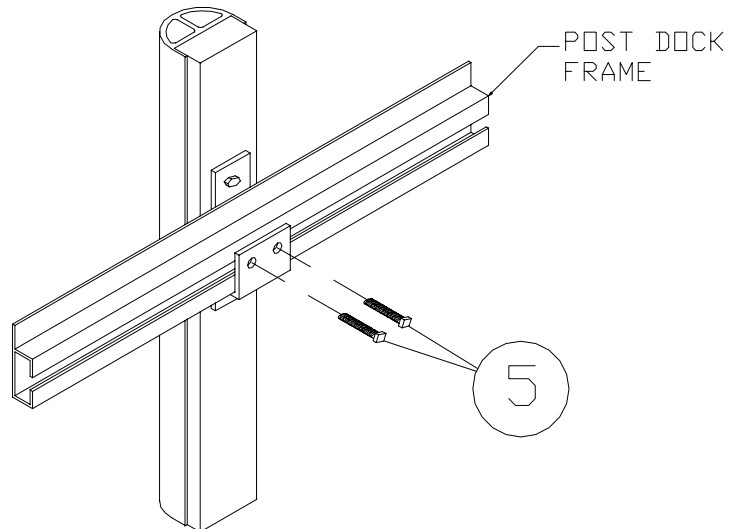

REF. #	PART #	DESCRIPTION	QTY
1	C88	VERT. PD. BUMPER BRACKET	1
2	C20	2' BUMPER	1
3	5082	3/8" X 2" BOLT	2
4	5070	3/8" WASHER	2
5	5173	1/2" X 2" SET SCREW	2