

### 10R BOAT MOTOR STOP (5000)

**Thank you for purchasing our product!**  
**\*Please read these instructions and follow them step by step. \***

**STEP 1.** Bolt the motor stop bracket (**REF. NO. 1**) in the center of the rear bed cross tube of the lift with a backer plate, 3/8" X 3 bolts, washers, and nuts (**REF. NO. 2, 4, 5, & 6**). Slide the motor stop T-bracket (**REF. NO. 3**) into the tube on the motor stop bracket (**REF. NO. 1**) and secure in desired position with a 1/2" X 1" set screw (**REF. NO. 7**).

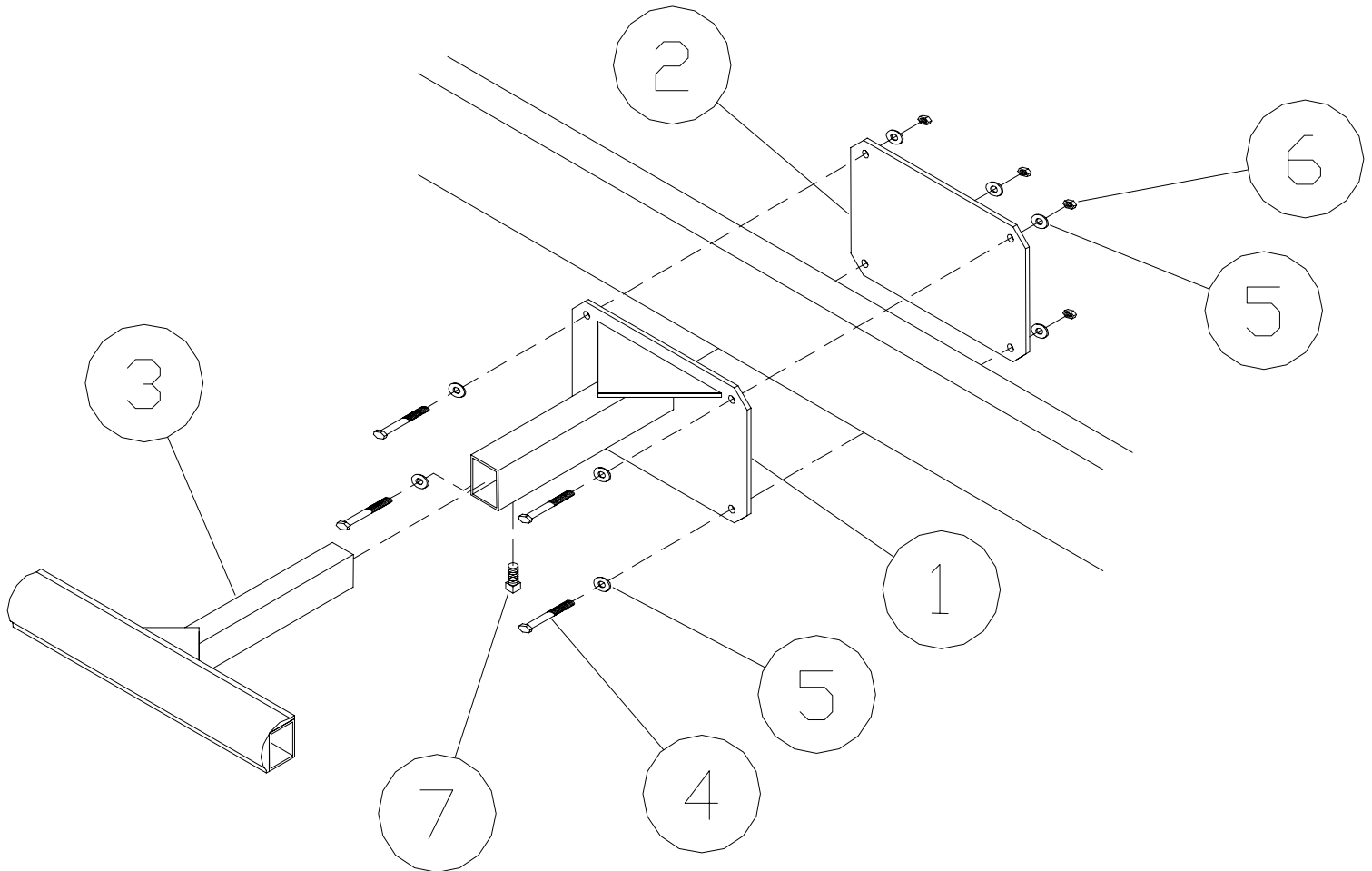

<u>REF. #</u>	<u>PART #</u>	<u>DESCRIPTION</u>	<u>QTY</u>
1	09F	MOTOR STOP BRACKET (5000)	1
2	60632	MOTOR STOP BACKER	1
3	07C	MOTOR STOP T-BRKT & BUMPER	1
4	5084	3/8" X 3" BOLT	4
5	5070	3/8" WASHER	8
6	5056	3/8" NUT	4
7	5174	1/2" X 1" SET SCREW	1